



COWAY LOVES THE PLANET
This paper can be recycled.

Coway

Water Filtration Device CHP-08AR/L

- This product can not be used if the voltage is different from that mentioned in the rating plate.
- For your safety and proper use of the product, please read this User's Manual before use.
- Warranty card is included in this User's Manual.

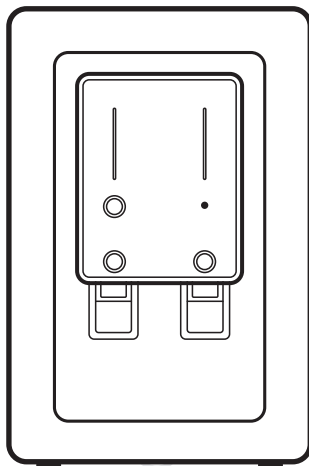

FEATURES



Hot water temperature control function

You can control the water temperature using the Hot-Warm Water Temperature Control Dial.



Mood lamp function

If you activate the mood lamp function, the mood lamp is lit when the light sensor senses insufficient light.



Power saving function using the light sensor

If you activate the power saving function, the number of motor and heater operations is automatically decreased and the power consumption is reduced.



Enhanced cooling capability

Composite material developed against various offensive odors that may be generated while drying food waste has been adopted to prevent offensive odors.



Polished design and easy installation

The tidy appearance that suits all locations such as a normal kitchen or living room, defies the limitations on conventional installation locations. This product is only ready if the power is connected.

CONTENTS

FEATURES	01
CONTENTS.....	01
SAFETY INFORMATION	02
PARTS NAME.....	05
- Front	05
- Rear	05
- Indication / Operation Part.....	06
WATER FILTRATION PROCESS	07
- CHP-08AR	07
INSTALLATION.....	08

HOW TO USE	09
- To Drink Cold Water.....	09
- To Drink Hot Water.....	09
- To Drink Room Water	09
- To Drink Warm Water	09
CLEANING METHOD.....	10
- Inside Water Tank	10
- Gutter	12
FILTER REPLACEMENT.....	13
- Filter Replacement Cycle.....	13
- Filter Replacement Method	13
TROUBLESHOOTING	15
SPECIFICATION	16
WARRANTY CARD	21

SAFETY INFORMATION

Be careful to keep this safety information.

Please read this information to prevent property loss and ensure your safety.



for 220 V - 240 V~ use only

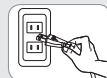

for 120 V~ use only

▲ Danger : Indicates an imminently hazardous situation which, if not avoided, will result in death or serious injury.

- Do not use a damaged power cord or plug, and loose outlet.
- Do not unplug by pulling the cord or handle the plug with wet hands.
- Do not run the power cord under a heavy object to prevent it from being damaged.
- If the cord or plug is wet, unplug the unit and let it completely dry before subsequent use.
- Unplug the unit before repair, inspection, or replacement.
- Do not plug into an outlet or power strip that is being used by several other appliances.
Use a separate outlet for the unit.
- Close the main water supply valve and unplug the power cord when not using for a long time.
- Do not attempt to repair the power cord.
- Do not repeatedly plug and unplug the unit from the electrical outlet.
- Do not use if the cord appears to be damaged. Please ask customer service to replace the cord.
- Remove any dust or water if it's on the plug.
Never use Benzene or gasoline to clean the plug.
- Do not install the unit near heaters.
- Close the main water supply valve and plug out, then call to A/S center in the case of any water leakage from the product.

SAFETY INFORMATION

- Do not place dishes or containers of water, drugs, food, or small metal objects on top of the product.
- Immediately unplug and call the customer service center if the unit makes a strange noise or odd smell.
- Do not put a candle, cigarette or any other flammable object on it.
- Do not carry the unit by its power cord.
- Do not spray water or wipe them with benzene when cleaning.
- Do not repair, disassemble, or modify.

▲ Warning : Indicates a potentially hazardous situation which, if not avoided, could result in death or serious injury.

- Do not turn or raise the product by holding the purified water extraction faucet.
- Since both the hot and warm water are hot, avoid contact with the water. Failing to do so may result in burns.
- This appliance is not intended for use by persons (including children) with reduced physical, sensory or mental capabilities, or lack of experience and knowledge, unless they have been given supervision or instruction concerning use of the appliance by a person responsible for their safety.
- Children should be supervised to ensure that they do not play with the appliance.
- This appliance can be used by children aged from 8 years and above.
- The new hose-sets supplied with the appliance are to be used and that old hose-sets should not be reused.

//////

⚠ Caution : Indicates a potentially hazardous situation which, if not avoided, may result in minor or moderate injury or damage to the product or other properties.

- Use or place the unit on a level area and do not apply force to the unit.
- Please use after completely closing the cover of the water tank in the product.
- Periodical filter replacement is prerequisite for getting clean water.
- When water is stored or the product is not in use for a long time, drain all the water in the storage tank before use.
- When moving the product or replacing the fine post-carbon filter there may be black residue particles under the tank bottom stored water may get contaminated.
- Do not use filtered water for the water exchange of an aquarium or a fishbowl.

PARTS NAME

Front

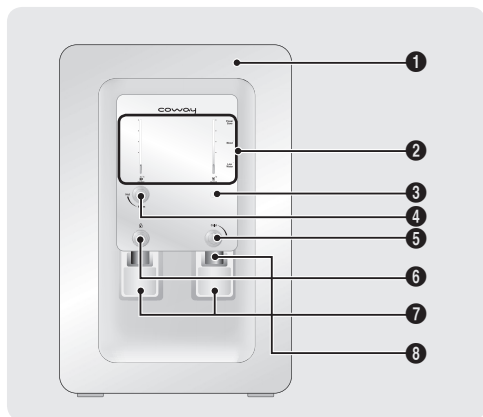

- ❶ Front Cover
- ❷ Indication Part
- ❸ Light Sensor
- ❹ Hot/Warm Water Temperature Control Dial
- ❺ Cold/Room Water Changeover Dial
- ❻ Hot Water Safety Button
- ❼ Cup-Touch Lever
- ❽ Water Faucet

Rear

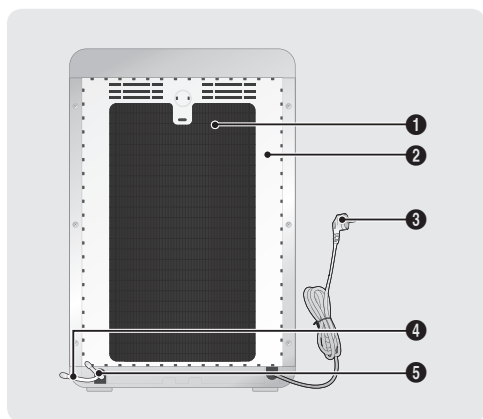

- ❶ Radiator
- ❷ Rear Cover
- ❸ Power Cord
- ❹ Outlet(Blue)
- ❺ Inlet(Orange)

Indication part

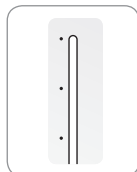

1 Hot water Temperature Indicator

According to the water temperature of hot water, the indicator is turned on. The more lamp on the indicators, the more hot water.

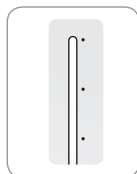

3 Cold water Temperature Indicator

According to the water temperature of cold water, the indicator is turned on. The more lamp on the indicators, the more cold water.



5 Power saving mode indicator

When selecting power saving mode, this indicator is turned on.



7 Low water level indicator

When the water level of the inner water tank becomes low, this indicator is turned on.

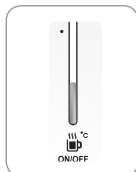

2 Hot water mode lamp

When selecting hot water mode, the indicator lamps on.



4 Cold water mode lamp

When selecting cold water mode, the indicator lamps on.



6 Mood lamp indicator

When selecting the mood lamp function, this indicator is turned on.



8 Light sensor

This sensor detects the room illumination of the product.

Operation part



1 Hot water mode selection button

Press this button to select/deselect hot water mode.



3 Hot/Warm water temperature control dial

Use this dial to control the hot and warm water temperature.



5 Hot water safety button

Press this button once before extracting the hot water. If you do not press the hot water safety button, the hot water will not be extracted even if you push the cup-touch lever.



2 Cold water mode selection button

Press this button to select/deselect cold water mode.



4 Cold/Room water changeover dial

Use the dial to select either the cold or the room-temperature water.



6 Power saving mode selection button

Press this button to select/deselect power saving mode.



7 Mood lamp selection button

Press this button to turn the mood lamp on or off.

WATER FILTRATION PROCESS

CHP-08AR

1, 2 Step : Neo-sense Filter

This neo-sense filter has the functions to remove particulates, dissolved organic and inorganic impurities. It also has the function to remove chlorine, volatile organic compounds(VOC's).

Step 3 : Membrane Filter (RO)

RO membrane filter has the function to remove water contaminants such as heavy metals, waterborne microorganisms and harmful organic chemicals etc.

The water concentrated the harmful material is flowed out through the daily life water hose as the daily life water..

Step 4 : Plus Inno-sense Filter

This Plus Inno-sense filter has the functions to remove smell induction material and to improve taste of water.

Step 5 : Antibacterial Filter

This Antibacterial Filter has the function to control microorganism propagation in water.



► Uses of the disposed water

- The disposed water should be used only for cleaning the house, cloths, or purposes other than drinking.
- Never use the disposed water for the drinking or as the food cooking.

INSTALLATION

1. Close main water supply valve to separate the faucet.

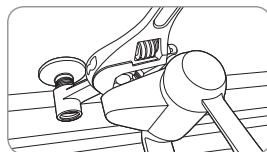

2. Wind the teflon tape on the adaptor and fit it to the pipe.

 Do not turn the water pipe.

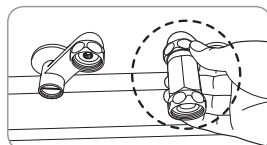

3. Connect the faucet with the adaptor.

 Shall install the adaptor with connector on the cold water pipe.

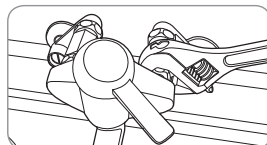

4. Connect ¼ inch orange tubing with the connector on the adaptor.

 Flush water through each filter at least 5 minutes before Connection.

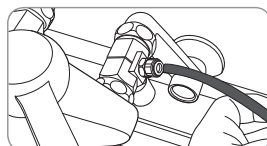

5. Connect it to voltage rating that matches it on the rating plate. Then, open the feed valve to supply water to the filtration system.

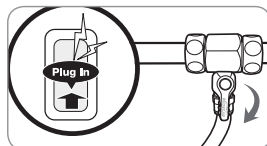

HOW TO USE

To drink cold water

Turn the Cold/Room water changeover dial counter clockwise and push the cup-touch lever.

Press the cold water mode selection button and check if the cold water mode indicator is turned on.



Tips

- When the cold water does not extract from the filtration system, please check if the cold water mode indicator is on.

To drink hot water

Turn the Hot/Warm water temperature control dial to the hot water position, press the safety button and then push the cup-touch lever.

Press the hot water mode selection button and check if the hot water mode indicator is turned on. Pressing the safety button just once is enough.



Tips

- When the hot water does not extract from the filtration system, please check if the hot water mode indicator is on.
- When using hot water, take care not to burn yourself.

To drink room water

Turn the Cold/Room water changeover dial to the right and push the cup-touch lever and you may drink room water of your desire.

To drink warm water

Turn the Hot/Warm water temperature control dial to the warm water position, press the safety button and then push the cup-touch lever.

Press the hot water mode selection button and check if the hot water mode indicator is turned on.



Tips

- Warm water mode mixes hot and cold water. The temperature of the warm water of this product is determined assuming that the hot and cold water of this product are at their standard temperatures. Therefore, if both the hot and the cold water temperature levels are not at their maximum, the warm water may be hotter or colder than the usual warm water temperature. In addition, when the low water level indicator is turned on, the warm water may be hotter than usual.
- Since warm water may be hot, take care not to burn yourself.

CLEANING METHOD

Inside Water Tank

- 1 Press and hold down each of the Cold and Hot water buttons on the front panel of the product for 2~3 seconds and unplug the power plug. Close the main water supply valve.

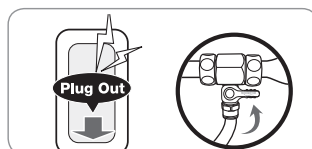

- 2 Please drain and store the water inside the water filtration device completely using the draining hose and the cold/room water extraction faucet.

Drain the water from the cold/room water tank through the cold/room water extraction faucet and drain the water from the hot water tank through the side drain plug.

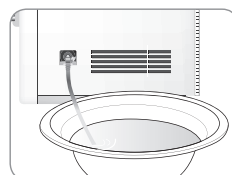

Tips

► To drain hot water

- Slide down the draining cover at the side of the product and connect the draining hose (continuous extraction hose) to drain the hot water from the hot water tank. (Take care not to burn yourself when draining hot water.)

- 3 Open the top cover of the product by sliding the cover backwards, open the fixing clips (6 points) of the inner water tank, and open the inner water tank cover by lifting it up.

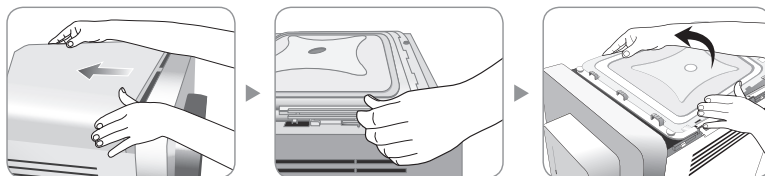

- 4 Separate the Antibacterial filter from the inner water tank cover and clean the Antibacterial filter by washing it in the drained water.

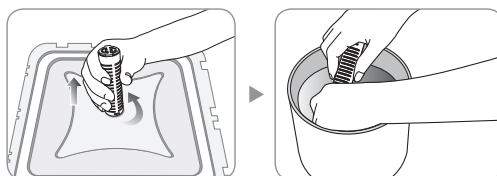

CLEANING METHOD

- 5** Wipe the inside of storage tank with a soft cloth.

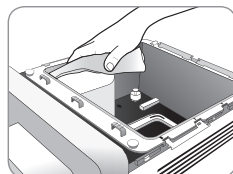

- 6** Wash out the storage tank with the drained water and drain it through the drain hose.

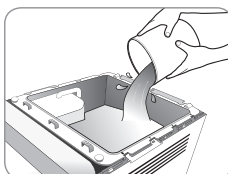

- 7** Install the Antibacterial filter into the inner water tank cover by turning the filter, closing the inner water tank cover and closing the fixing clips (6 points) of the inner water tank.

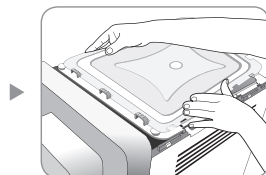
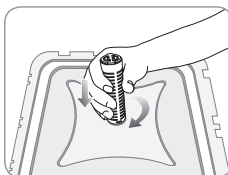

- 8** After closing the top cover and connecting the power plug, open the main water supply valve. Please operate the water filtration device again by pressing the cold water/hot water mode selection button at the front of the product after checking if the water is coming from the cold water/room water extraction faucet and the hot water extraction faucet.

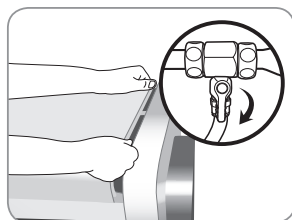

Gutter

① Gutter separation method

You can easily separate the gutter by pulling the front part of the gutter forwards.

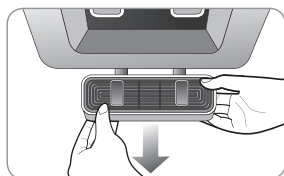

② Gutter assembling method

Simply push the gutter hook slightly after sticking it onto the product.

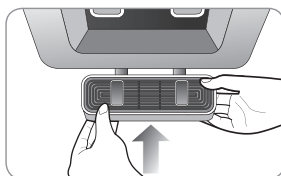

Tips

⚠ When cleaning storage tank do not use chemicals or detergents.

- When the chemicals and detergents are not washed out completely it may be harmful to health.

Please always keep environment clean and clean the storage tank once every two months.



Chemicals or Detergents

FILTER REPLACEMENT

■ Filter Replacement Cycle

If the filter is not regularly replaced, it may degrade the water quality from the product. The filter change cycle may vary within the range of expected replacement cycle depending on the feed water quality.



Tips

The period for the filter exchange is made based on 10 L use in a day for house use (4 people based).

CHP-08AR

Filter name	Expected Replacement Cycle
	Reverse osmosis
Neo sense filter	6 months
Membrane filter (RO)	24 months
Plus Inno-sense filter	18 months
Antibacterial filter	12 months

■ Filter Replacement Method

- ❶ Close the main water supply valve after unplugging the power cord, and drain the water inside of the water filtration device.

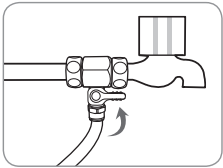
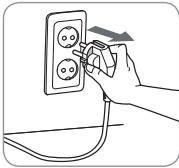

- ❷ Separate the top cover.

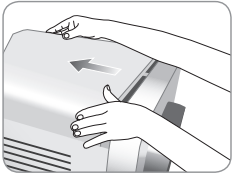

- 3 Remove the 2 fixing screws with a star screwdriver. Hold the top of the front cover, pull it forwards to separate it, and then disconnect all the connected cables to separate it completely.

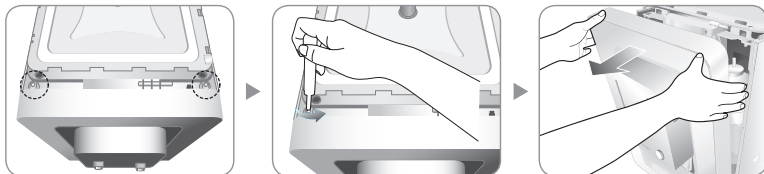

- 4 After separating the fitting connected to the filter to replace, please replace the filter. (Separate the fitting using the proper tool.)

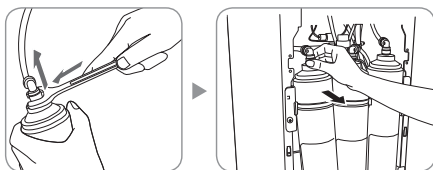

Tips

By changing the filter and connecting the fitting and the hose precisely, check that there is no leakage and drain the first purified water necessarily.

- 5 Connect all the separated cables, align the 3 holes of the front cover and the 3 buttons, and close the cover pushing it towards the product.

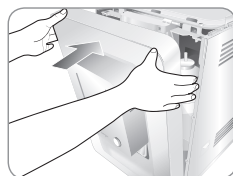

Tips

⚠ Please be sure to use the new filter after cleansing.

- Neo-sense filter : Please assemble after cleansing with neo-sense filter for about 30 seconds.
- Membrane filter (RO) : After cleansing with the main water passed neo-sense filter for about 3 minutes, please assemble it.
- Plus Inno-sense filter : Please use the filter without flushing.

TROUBLESHOOTING

The water filtration device may operate abnormally because the user is unfamiliar with the product or due to some other reason and not because of a product malfunction. In such a case, problems can be easily solved without help from the service center by checking the following. If the problem is not solved after checking the following, please call the service center.

Symptom	Check	Measures to take
The water tastes odd.	• Did you clean the internal water tank?	Clean the internal water tank.
	• The water filtration device has not been used for a long time.	Get rid of the stored water and clean the internal water tank.
	• Is it time to replace the filter?	Request a filter replacement.
No water is emitted.	• Is the water supply cut or is the water supply valve closed?	Open the main water supply valve.
	• Was the filter not replaced at the correct time?	Request a filter replacement.
The amount of filtrated water has suddenly decreased.	• Is it time to replace the filter?	Request a filter replacement.
	• Is the power connected?	Check if the power cord is plugged into a 220 V~60 Hz wall outlet.
	• Did you close the main water supply valve?	Open the main water supply valve.
	• Did the temperature of the feed water drop suddenly?	If the water temperature has decreased, the amount of filtrated water decreases.
No cold water is emitted.	• Is the cold water lamp lit?	Turn the cold water function on by pressing the cold water button.
	• Is the power saving function turned on?	If the power saving function is turned on, the water may not be as cold as usual.
	• Was the cold water lamp lit?	Press the cold water button.
	• Did you close the main water supply valve?	Open the main water supply valve.
	• Is the back of the water filtration device to close to the wall?	Please keep a distance of at least 10 cm between the back of the water filtration device and the wall.
No hot water is emitted.	• Is the hot water lamp lit?	Turn the hot water function on by pressing the hot water button.
	• Is the power saving function turned on?	If the power saving function is turned on, the water may not be as hot as usual.
	• Did you close the main water supply valve?	To prevent the heater from over-heating, the heater function will not work if the water level is low. Open the main water supply valve.
	• Is the hot-warm water control dial turned to the warm water position?	If the hot-warm water control dial is turned to the warm water position, warm water is emitted. Turn the dial to the right-most position.

Symptom	Check	Measures to take
The mood lamp is not turned off.	• Is the mood lamp function lamp turned on?	Press the mood lamp function button to turn it on.
	• Is the room illumination bright?	The mood lamp is turned on when the room illumination is dark (Threshold: 1 LUX)
All operations have suddenly stopped while operating.	• Is the main water being supplied?	Check the main water supply valve.
	• Is the power connected?	Check if the power cord of the product is plugged into a 220 - 240V~, 50Hz / 60Hz wall outlet.
	• Is water overflowing or leaking?	In this case, please contact the service center.

SPECIFICATION

Product Name		Water Filtration Device	
Model		CHP-08AL	CHP-08AR
Purified Method		Reverse Osmosis	
Rated Voltage		Refer to the rating Plate.	
Power Consumption		Cool: 0.7 A, Heater: 325 W	
Tank capacity	Room water	6.4 L	
	Cold water	3.7 L	
	Hot water	1.2 L	
	Total water	11.3 L	
Dimension		340 mm(W) X 523 mm(D) X 518.7 mm(H)	
Net Weight		18.7 kg	20.5 kg
Working Pressure		137 kPa – 827 kPa	69 kPa – 827 kPa
Working Temperature		5 °C- 35 °C	

- The water amount can be differentiated according to the water pressure and the water temperature.
- The water tank capacity is the amount by the size and can be different from the extraction capacity.
- Without any prior notice, all or parts of the product are subject to change for the purpose of improving the performance of the product.

MEMO

////////////////////////////////////

MEMO

////////////////////////////////////

MEMO

////////////////////////////////////

MEMO

////////////////////////////////////

WARRANTY CARD OR WARRANTY LETTER
ONE YEAR LIMITED WARRANTY
WATER FILTRATION DEVICE CHP-08AR ("PRODUCT")

Model:

Serial Number:

Customer Name:

Date of Purchase:

("OWNER")

What This Warranty Covers:

Commencing with the date of purchase of the Product and continuing for a period of one year, if manufacturing defects in the Product cause the Product to not operate properly for its intended use, then subject to the exclusions, conditions, and limitations contained herein, COWAY at its sole option will repair or replace the Product.

Decisions as to the extent of repair or replacement required will be made solely by COWAY.

The remedy under this Warranty is available only for that portion of the Product exhibiting defects at the time of the warranty claim. The replacement Product as well as any remaining original Product will be warranted only for the original one year warranty period. This limited warranty applies only to Product used for an application specified by COWAY for the Product and applied in strict accordance with COWAY published specifications in effect at the time of application. IF PRODUCT IS USED FOR OTHER THAN ITS INTENDED PURPOSE, IT IS SOLD AS IS AND WITHOUT ANY EXPRESS OR IMPLIED WARRANTIES, INCLUDING OF MERCHANTABILITY OR FITNESS FOR A PARTICULAR PURPOSE.

What This Warranty Does Not Cover:

This Warranty warrants that the Product will be free from manufacturing defects which affect the ability of the Product to operate for its intended use; it is not a warranty that the Product will never require repairs or to undertake responsibilities, liabilities or obligations other than those specifically identified in the preceding section. COWAY is not responsible or liable for personal injury or property damage of any kind, even if arising from a breach of this Warranty.

Limitations and Exclusions:

TO THE EXTENT PERMITTED BY APPLICABLE LAW, COWAY DISCLAIMS ANY OTHER WARRANTY EXPRESS OR IMPLIED, THAN THAT GUARANTEES FOR HEREIN. THIS WARRANTY IS IN LIEU OF AND EXCLUDES ALL OTHER WARRANTIES, PROVIDES, CONDITIONS AND REPRESENTATIONS, EXPRESS OR IMPLIED, ORAL OR WRITTEN, STATUTORY OR OTHERWISE, INCLUDING BUT NOT LIMITED TO ANY IMPLIED CONDITIONS OR WARRANTIES AS TO THE MERCHANTABILITY OR FITNESS FOR A PARTICULAR PURPOSE OF THE COWAY PRODUCT. SOME STATES DO NOT ALLOW LIMITATIONS ON HOW LONG AN IMPLIED WARRANTY LASTS, SO THE ABOVE LIMITATION MAY NOT APPLY TO YOU. COWAY DOES NOT AUTHORIZE ANY PERSON INCLUDING ITS REPRESENTATIVES, TO MAKE ANY REPRESENTATION OR TO OFFER ANY WARRANTY, CONDITION OR GUARANTY IN RESPECT OF THE PRODUCT OTHER THAN THIS WARRANTY. THIS LIMITED WARRANTY SHALL BE THE OWNER'S SOLE AND EXCLUSIVE REMEDY AGAINST COWAY AND COWAY SHALL NOT BE LIABLE FOR ANY CONSEQUENTIAL, EXEMPLARY, SPECIAL, INCIDENTAL OR OTHER DAMAGES INCLUDING, BUT NOT LIMITED TO, LOSS OF PROFITS, AND LOSS OF USE. INCIDENTAL, CONSEQUENTIAL AND EXEMPLARY DAMAGES SHALL NOT BE RECOVERABLE EVEN IF THE REMEDIES OR THE ACTIONS PROVIDED FOR IN THIS WARRANTY FAIL OF THEIR ESSENTIAL PURPOSE. SOME STATES DO NOT ALLOW THE EXCLUSION OR LIMITATION OF INCIDENTAL OR CONSEQUENTIAL DAMAGES, SO THE ABOVE LIMITATION OR EXCLUSION MAY NOT APPLY TO YOU. COWAY SHALL NOT BE LIABLE FOR ANY DAMAGES WHICH ARE BASED UPON NEGLIGENCE, BREACH OF WARRANTY, STRICT LIABILITY OR ANY OTHER LEGAL THEORY OF LIABILITY OTHER THAN THE EXCLUSIVE LIABILITY SET FORTH IN THIS WARRANTY

Limitations on Implied Warranties:

Any implied warranty of merchantability or fitness for a particular purpose or use, shall be limited to the duration of the foregoing express written warranty.

Conditions of Warranty:

COWAY's continuing liability under this Warranty is conditioned upon the following :

- a) The defect or damage is not caused by or is the result of : abnormal use or conditions; improper storage, unauthorized modifications or repair; misuse, neglect, accident, alteration, improper installation or other acts that are not the fault of Coway or the manufacturer of the product or that are not covered by the manufacturer's warranty;
- b) The Product has not been altered, modified or repaired without prior written approval of COWAY;
- c) The OWNER has notified COWAY in writing of any failure of the Product covered by this Warranty within thirty (30) days following such failure;
- d) There has been no misuse, abuse or negligence with respect to the Product on the part of the OWNER.

Waiver:

COWAY's failure at any time to enforce or rely upon any of the terms or conditions stated herein shall not be construed to be a waiver of its rights hereunder.

Obtaining Warranty Service and OWNER'S Duties:

If the Product fails to operate for its intended purpose, then notify Coway or its Representative Agency within 48 hours or within the next business day after discovery of any defect in the Product. The OWNER must give written notice to COWAY no later than thirty (30) days after a defect is discovered or should by reasonable diligence have been discovered. Claims under this Warranty will require proof of purchase by the OWNER.

COWAY

Add : Coway co., Ltd.
136-23, Yugumagoksa-ro, Yugu-eup, Gongju-si,
Chungcheongnam-do, Korea
Tel. : 82-41-850-7879
Fax. : 82-41-841-7816

USA

Add : WOONGJIN COWAY USA,INC
4221 Wilshire Blvd. #210 Los Angeles, CA90010
Call center. : (213) 386-3033
Fax. : (213) 386-3032

THAILAND

Add : COWAY(THAILAND) CO., LTD.
No.75/104-106,38TH FL,OCEAN TOWER 2 BUILDING,
SOI SUKHUMVIT 19,KLONGTON NUA,WATTANA,
BANGKOK,THAILAND ZIP CODE:10110
HQ : 001-66-2-261-2610
Call center : 001-66-2-315-7578

MALAYSIA

Add: COWAY (M) SDN BHD
SUITE 6-3 & 6-4 LEVEL 6, WISMA UOAI
NO.21 JALAN PINANG 50450 KUALA LUMPUR
kuala Lumpur
Call center : 1-800-888-112

coway

www.coway.com