



COWAY LOVES THE PLANET
This paper can be recycled.

COWAY

Water Purifier P-350N

• For your safety and proper use of the product, please read this User Manual before use.

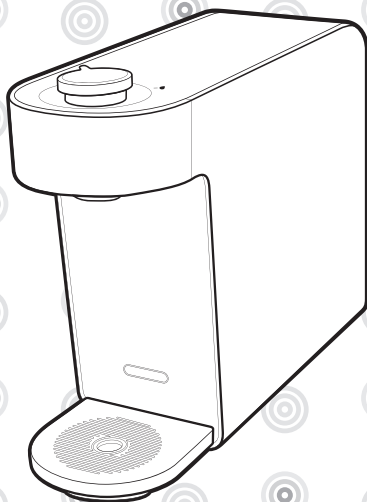

FEATURES

1

3 filters, 4-stage filtration

4-stage filtration with Nanotrap™ system helps to provide healthy and safe drinking water.

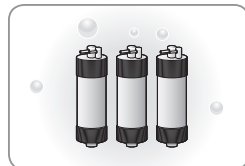

2

No electricity required

Does not consume electricity, so you can operate it without worrying about power consumption.



3

Convenient continuous extraction

Enjoy continuous water extraction with just a simple twist of the knob.



4

Elegant and slim design

Space saving size allows it to fit into any kitchen.



DEAR CUSTOMERS

Thank you for using **Coway Water Purifier.**
Please read this User Manual to learn about the proper usage and maintenance of the product.
When a problem occurs while using the product, it can be solved by referring to the instructions in this manual.

CONTENTS

Product Information

- |03| Safety Information
- |05| Parts Name
- |06| Water Filtration Process

How to Use

- |07| Please Check Before Use
- |08| How to Get Purified Water

Maintenance

- |09| How to Install
- |11| How to Clean
- |12| Filter Replacement
- |13| How to Replace the Filter

Others

- |15| Troubleshooting
- |16| Product Specifications
- |17| Water Flow Diagram
- |21| PERFORMANCE DATA SHEET

SAFETY INFORMATION



Danger

When mortality or fatal injury is predicted for not following instruction.



Warning

When severe bodily harm or property damage is predicted for not following instruction.



Caution

When minor bodily harm or property damage is predicted for not following instruction.

Regarding Installation



Do not install near electric heating device.

There is risk of fire.



Do not store or use flammable gases or materials near the product.

There is risk of fire.



Do not install it on a tilted surface.

There is risk of bodily harm and product damage.

During Use



Please turn off the tap water valve and contact the Service Center if there is water leaking from inside the product or if water is puddling around the product.



Do not place candles or cigarettes on top of the product.

There is risk of fire.



Do not place a bowl filled with water, chemicals, food, small metals, or flammable substances on top of the product.

There is risk of fire and product damage if product is exposed to them.



Please replace the filters according to the filter replacement cycle to have clean drinking water.

Using expired filter decreases water purification performance.







Ensure that the covers are completely closed.

Bugs and debris may enter the product.



Drain the water for 1 minute when using the product after an extended period.

Others

-  **Do not directly spray water on the product for cleaning or use benzene or thinner to wipe the product.**
There is risk of fire.
-  **Do not arbitrarily open, repair, or remodel the product.**
There is risk of product damage.
-  **Do not use the filtered water for replacing water in fish tanks and aquariums.**
Water filtered through membrane does not contain ion substances which may be inappropriate for living environment of fish. There is risk of fish mortality depending on the circumstances.
-  **Do not rotate or lift the product by grabbing on to the filtered water extraction valve.**
This causes water leaking and product damage.
-  **Do not use any water source other than tap water.**

PARTS NAME

Front

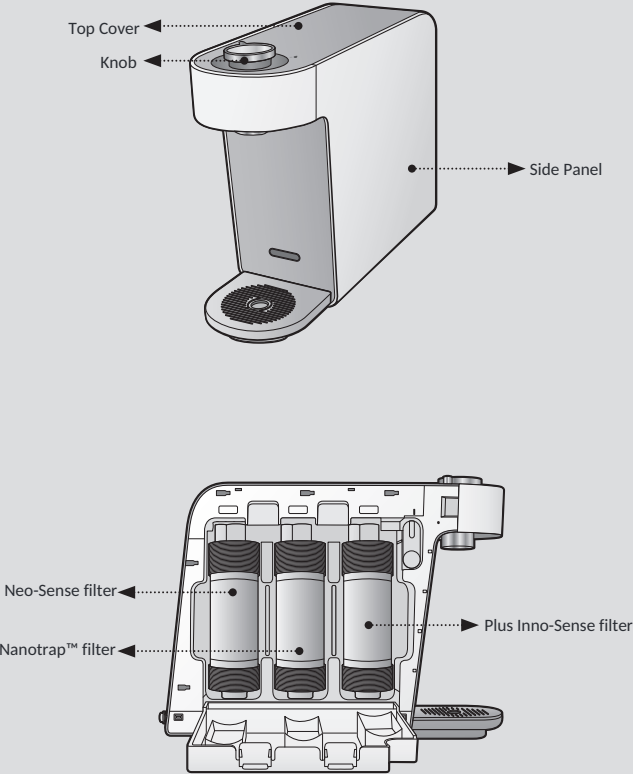

WATER FILTRATION PROCESS

The essence of the water filtration system lies in the filters.

Using an uncertified filter; or even using a certified yet expired filter may reduce filter performance.

4-Step Water Filtration System

Step 1, 2 : Neo-Sense filter

This Neo-Sense filter has the function of removing particulates, dissolved organic and inorganic impurities. It also has another function to remove chlorine, volatile organic compounds (VOC's).

Step 3 : Nanotrap™ filter

Removes particulates in drinking water.

It also has the function to remove waterborne microorganisms, bacteria and viruses.

Step 4 : Plus Inno-Sense filter

This Plus Inno-Sense filter has functions to remove smell inducing material and to improve the taste of water.

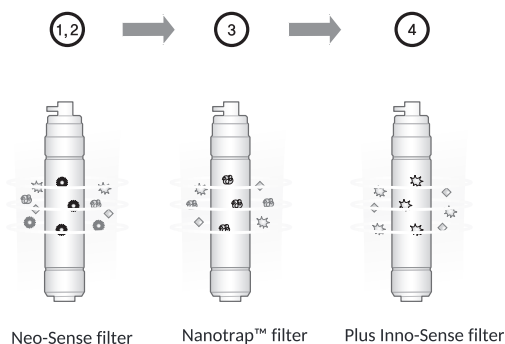

* Air bubbles formed during extraction from direct flow products may temporarily appear due to water pressure fluctuations. The air bubbles will disappear naturally and will not affect the water quality.

* Boiling purified water from a water purifier can cause white precipitates. This is caused by the precipitation of minerals in the water, not foreign matter.

PLEASE CHECK BEFORE USE

Please Check Before Use

■ Open the tap water valve.

Tap water must be supplied for operation.

■ After product installation.

Drain the water from water purifier for 1 minute before start using it.

■ Regular filter replacement.

Regular filter replacement is crucial for clean drinking water.

Using expired filter will decrease the water filtration performance. Customer is advised to replace the filter on time.



Tips

- Turn off the tap water valve when product is not in use for a long time.

HOW TO GET PURIFIED WATER

How to Get Purified Water

1. Place the cup under the extraction faucet.

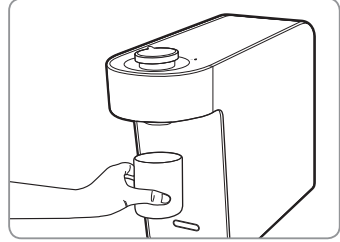

2. Rotate the knob clockwise to the extraction mark.

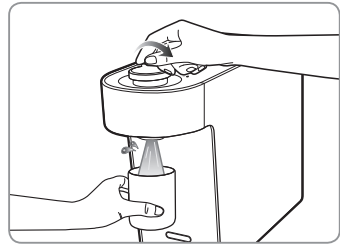

3. To stop extraction, rotate the knob counterclockwise.

* If it is not fully rotated, water leakage may occur.

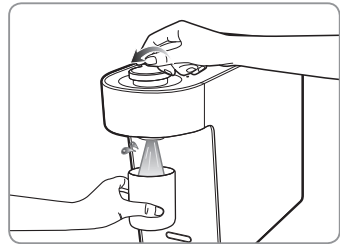

HOW TO INSTALL

Installation Guide

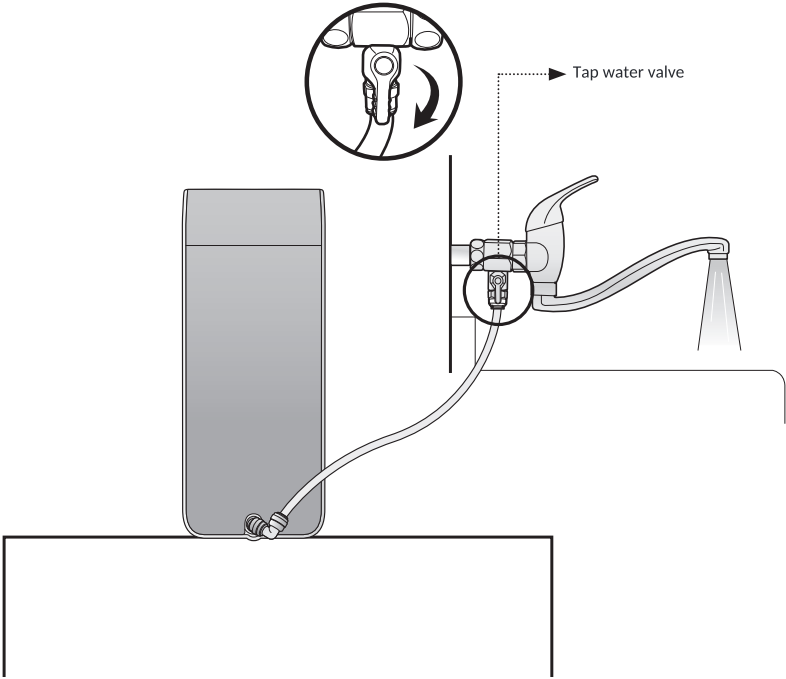

Connect the orange tubing to (1), and the tap water pipe.

Connect tubing (Orange) from water source to here.

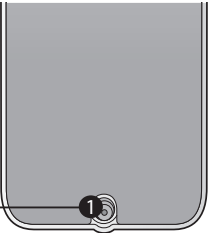

Be Careful!**⚠ Where to install the water filtration unit I**

Install the product in a cool part of the room, on an even surface, out of direct sunlight and away from humidity, dust and dripping water.

⚠ Where to install the water filtration unit II

Install the product on a flat and stable surface.

⚠ After installing the water filtration unit

Drain the water from the water purifier for 1 minute before starting to use it.

⚠ Water piping caution

Do not connect with tubing from a warm water source or the filter may be damaged.

**Tips**

Some residual water in filters is caused by product inspection.



Do not use recycled tap water valve and tubing for product installation.

HOW TO CLEAN

Faucet Cleaning

1. Detach the faucet by turning it clockwise.

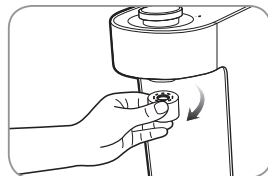

2. Rinse the faucet with water.



3. After rinsing, wipe the faucet with a soft, dry cloth.

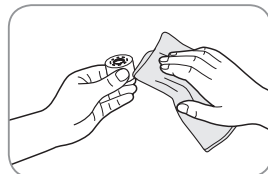

4. Attach the faucet back by turning it counterclockwise.

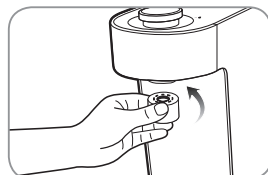

Cleaning (once every 2~4 weeks)

Wipe the product with a clean towel.

* For thicker layers of dust, use a wet towel to wipe.
(Do not use abrasives)



FILTER REPLACEMENT

Filter replacement

■ Filter Replacement Cycle

If the filters are not regularly replaced, it may degrade the water quality of the product.
The filter changing cycle may vary depending on the source water quality.

P-350N

Filter Name	Expected Replacement
Neo-Sense filter	4 months
Nanotrap™ filter	12 months
Plus Inno-Sense filter	8 months

■ About Filter Replacement Cycle

The period for filter change is calculated based on 10 L water usage per day for a household of 4 members.

HOW TO REPLACE THE FILTER

Filter replacement

1. Open the side cover and internal filter cover.

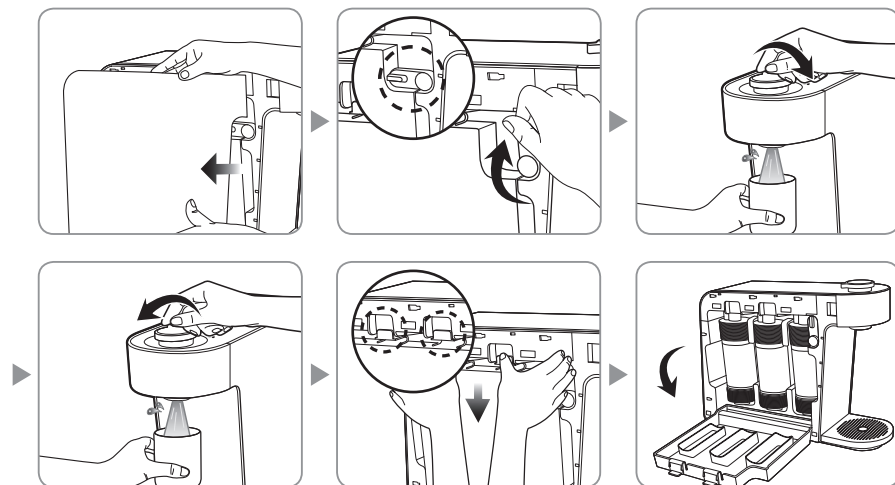

Tips

- Please do not use excessive force on the product as it will cause damage.
- To ensure water is completely drained from the product, close the main water source, and drain remaining water by turning the knob for 3 seconds and close it back.

2. Replace the filters.

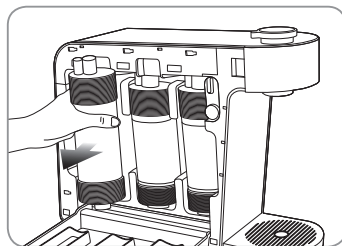

Tips

- ⚠ After the replacement of filters, please ensure the filters are securely installed and drain the water purifier for 1 minute before use.

3. Close the filter cover, lock and close the side cover.

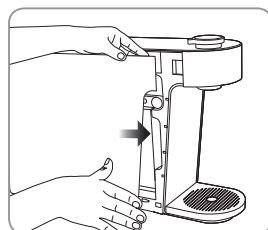
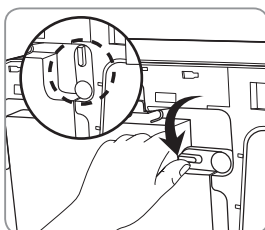
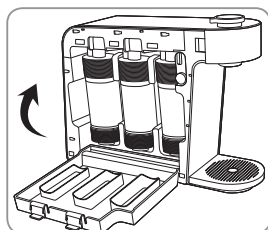

Tips

- ⚠ Please flush the filters before installation.
- Neo-Sense filter: Please assemble after flushing the Neo-Sense filter for about 1 minute.
 - Nanotrap™ filter: Please assemble after flushing with the Neo-Sense filter for about 3 minutes.
 - Plus Inno-Sense filter: Please use the filter without flushing.

*Flushing refers to a large quantity of water passing through the filter to cleanse the internal parts.

TROUBLESHOOTING



The water purifier may operate abnormally due to minor causes not because the product is malfunctioning but because the user is not familiar with the proper product usage. In such a case, problems can be solved easily even without the help from the Service Center by checking the following terms. If you can't solve the problem after checking the following items, please call the Service Center.

Symptom	Check	Measures to take
Water tastes weird.	<ul style="list-style-type: none">I haven't used the water filtration device for a very long time.	Please drain the device for about 1 minute.
	<ul style="list-style-type: none">Isn't it time for filter replacement?	Please request for filter replacement.
Water is not being dispensed.	<ul style="list-style-type: none">Is the device disconnected from the water supply or is the tap water valve locked?	Please turn on the tap water valve.
	<ul style="list-style-type: none">Did you miss the filter replacement period?	Please request for filter replacement.
The filtration amount has suddenly decreased.	<ul style="list-style-type: none">Isn't it time for filter replacement?	Please request for filter replacement.
	<ul style="list-style-type: none">Is the tap water valve locked?	Please turn on the tap water valve.
Water leaks from the product.	<ul style="list-style-type: none">Leakage in the water purifier.	Please close the tap water valve and contact customer service as soon as possible.

PRODUCT SPECIFICATIONS

Product Name	Coway Water Purifier
Model	P-350N
Filtration Method	Nanotrap™
Size (W x D x H)	130 mm(width) × 402.7 mm(depth) × 308 mm(height)
Weight	3.3 kg
Working Temperature	5 °C - 35 °C

► For product improvement purposes, product specifications are subject to change without prior notice.

WATER FLOW DIAGRAM



P-350N

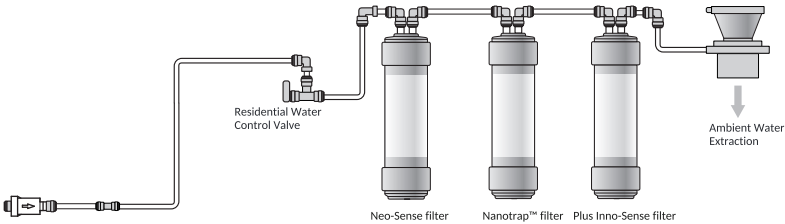

MEMO

////////////////////////////////////

MEMO

////////////////////////////////////

MEMO

////////////////////////////////////

Water Filtration System Performance Data Sheet



Model: P-350N

This system has been tested and certified by the Water Quality Association according to NSF/ANSI 42, 53, 58, and 401 for the reduction of the substances listed below. The concentration of the indicated substances in water entering the system was reduced to a concentration less than or equal to the permissible limit for water leaving the system, as specified in NSF/ANSI 42, 53, 58, and 401.

Substance	Influent Challenge Concentration (mg/L unless specified)	Maximum Allowable Product Water Concentration (mg/L unless specified)	Percent reduction (%)
Aesthetic Chlorine	2.00 ± 10%	≥50% Reduction	79.2%
Particulate Class I	at least 10 000 particles/mL	≥85%	91.3%
Turbidity	11 ± 1 NTU	0.5 NTU	96.6%
VOC*	0.300 ± 10%	≥95% Reduction	99.7%

While testing was performed under standard laboratory conditions, actual performance may vary.

General Operating Information:

Rated Capacity	150 gallons (for VOCs) 5 000 gallons (for Aesthetic Chlorine)
Min-Max operating pressure:	20 ~ 120 psi (138 KPa ~ 827 KPa)
Min-Max operating temperature:	40 °F ~ 100 °F (4.4 °C ~ 37.8 °C)
Rated Service Flow	0.5 gpm (1.9 LPM)

- Do not use with water that is microbiologically unsafe or of unknown quality without adequate disinfection before or after the system.
- Refer to the owner's manual for specific installation instructions, manufacturer's limited warranty, user responsibility, and parts and service availability.
- For parts and service availability, please contact your local dealer or Coway.
- The estimated replacement time of filter, which is a consumable part, is not an indication of quality guarantee period, but it means the ideal time of filter replacement. Accordingly, the estimated time of filter replacement may be shortened in case it is used in an area of poor water quality.

Model of Filter	Type	Usable Period (months)
CNFN8S	NEO-SENSE FILTER	4 months
CNTFN8S	NANOTRAP™ FILTER	12 months
CIFN8S-D-PLUS	PLUS INNO-SENSE FILTER	8 months

* VOC Surrogate Claims

Chemical	Drinking water regulatory level ¹ (MCL/MAC) mg/L	Influent challenge concentration ² mg/L	Chemical reduction percent	Maximum product water concentration mg/L
alachlor	0.002	0.050	> 98	0.001 ³
atrazine	0.003	0.100	> 97	0.003 ³
benzene	0.005	0.081	> 99	0.001 ³
carbofuran	0.04	0.190	> 99	0.001 ³
carbon tetrachloride	0.005	0.078	98	0.0018 ⁴
chlorobenzene	0.1	0.077	> 99	0.001 ³
chloropicrin	-	0.015	99	0.0002 ³
2,4-D	0.07	0.110	98	0.0017 ⁴
dibromochloropropane(DBCP)	0.0002	0.052	> 99	0.00002 ³
o-dichlorobenzene	0.6	0.080	> 99	0.001 ³
p-dichlorobenzene	0.075	0.040	> 98	0.001 ³
1,2-dichloroethane	0.005	0.088	95 ⁵	0.0048 ⁵
1,1-dichloroethylene	0.007	0.083	> 99	0.001 ³
cis-1,2-dichloroethylene	0.07	0.170	> 99	0.0005 ³
trans-1,2-dichloroethylene	0.1	0.086	> 99	0.001 ³
1,2-dichloropropane	0.005	0.080	> 99	0.001 ³
cis-1,3-dichloropropylene	-	0.079	> 99	0.001 ³
dinoseb	0.007	0.170	99	0.0002 ¹
endrin	0.002	0.053	99	0.00059 ¹
ethylbenzene	0.7	0.088	> 99	0.001 ³
ethylene dibromide (EDB)	0.00005	0.044	> 99	0.00002 ³
haloacetonitriles (HAN)				
bromochloroacetonitrile	-	0.022	98	0.0005 ³
dibromoacetonitrile	-	0.024	98	0.0006 ³
dichloroacetonitrile	-	0.0096	98	0.0002 ³
trichloroacetonitrile	-	0.015	98	0.0003 ³
haloketones (HK):				
1,1-dichloro-2-propanone	-	0.0072	99	0.0001 ³
1,1,1-trichloro-2-propanone	-	0.0082	96	0.0003 ³
heptachlor (H-34,Heptox)	0.0004	0.08	> 99	0.0004
heptachlor epoxide	0.0002	0.0107 ⁶	98	0.0002 ⁶
hexachlorobutadiene	-	0.044	> 98	0.001 ³
hexachlorocyclopentadiene	0.05	0.060	> 99	0.000002 ³
lindane	0.0002	0.055	> 99	0.00001 ³
methoxychlor	0.04	0.050	> 99	0.0001 ³
pentachlorophenol	0.001	0.096	> 99	0.001 ³
simazine	0.004	0.120	> 97	0.004 ³
styrene	0.1	0.150	> 99	0.0005 ³
1,1,2,2-tetrachloroethane	-	0.081	> 99	0.001 ³
tetrachloroethylene	0.005	0.081	> 99	0.001 ³
toluene	1	0.078	> 99	0.001 ³
2,4,5-TP (silvex)	0.05	0.270	99	0.0016 ³
tribromoacetic acid	-	0.042	> 98	0.001 ³
1,2,4-trichlorobenzene	0.07	0.160	> 99	0.0005 ³
1,1,1-trichloroethane	0.2	0.084	95	0.0046 ⁶
1,1,2-trichloroethane	0.005	0.150	> 99	0.0005 ³
trichloroethylene	0.005	0.180	> 99	0.0010 ³
trihalomethanes (includes):				
chloroform (surrogate chemical)				
bromoform	0.080	0.300	95	0.015
bromodichloromethane				
chlorodibromomethane				
xylene (total)	10	0.070	> 99	0.001 ³

The Coway logo is displayed in a white, lowercase, sans-serif font. The letters are closely spaced, with the 'w' and 'a' being particularly prominent. The logo is centered within a dark gray horizontal bar that spans the width of the page.

www.coway.com