



COWAY LOVES THE PLANET
This paper can be recycled.

Coway

Water Filtration Device CHP-590N

- This product can not be used if the voltage is different from that mentioned in the rating plate.
- For your safety and proper use of the product, please read this User's Manual before use.
- Warranty card is included in this User's Manual.

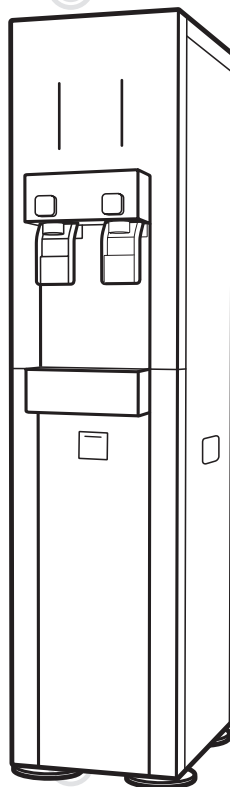

FEATURES

1

A display to show the status at a glance

This display uses various indicators so you can see the product's status conveniently at a glance.

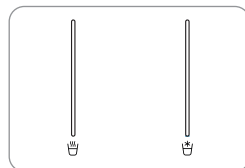

2

Hot water safety tap

A safety equipment is installed on the hot water tap to prevent burns from hot water (90 °C or more).

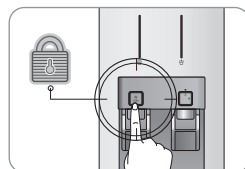

3

Front draining system

You can conveniently drain hot water from the front of the product by opening the front drain cover, so you don't need to move the product to drain it.



4

Dust prevention

This purifier uses a Plus Inno-Sense filter (D) to minimize the amount of dust particles entering the interior tank.



DEAR CUSTOMERS

Thank you for using **Coway Water Filtration Device**.

Please read this Users' Manual to use and maintain the product correctly.

If you encounter a problem while using the product, you may solve the problem referring to the User's Manual. As this manual contains the product warranty card, please keep it in a safe place.

CONTENTS

FOR INFORMATION

- | 03 | **SAFETY INFORMATION**
 - Danger
 - Warning
 - Caution
- | 07 | **PARTS NAME**
- | 09 | **WATER FILTRATION PROCESS**

MAINTENANCE

- | 16 | **INSTALLATION**
- | 18 | **CLEANING METHOD**
 - Storage tank
 - Gutter
 - Main body
 - Faucets
 - Cup-Touch Lever
- | 22 | **FILTER REPLACEMENT**
- | 23 | **FILTER REPLACEMENT METHOD**

HOW TO USE

- | 10 | **INSTALLATION PRECAUTIONS**
- | 12 | **INDICATION / OPERATION PART**
- | 14 | **HOW TO USE**
 - To drink the cold water
 - To drink the hot water
 - To drink the room water

OTHERS

- | 24 | **TROUBLESHOOTING**
- | 25 | **SPECIFICATION**
- | 26 | **WATER FLOW DIAGRAM**
- | 27 | **PERFORMANCE DATA SHEET**
- | 29 | **WARRANTY CARD**

SAFETY INFORMATION

Be careful to keep this safety information.

Please read this information to prevent property loss and ensure your safety.



for 220 V - 240 V~ use only

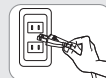

for 120 V~ use only

▲ Danger : If not observed, serious injury or even death could occur.

- Do not use a damaged power cord or plug, and loose outlet.
- Do not pull the power cord.
- Do not carry the unit by its power cord.
- Do not touch the power plug with a wet hand.
- Do not forcefully bend the power cord or put it under a heavy object to prevent it from being damaged or deformed.
- Do not connect and pull out the power plug repeatedly.
- Remove any dust or water off in the pin and contacts of the power plug.
- Do not plug into an outlet that is being used by several other appliances.
Use an electrical outlet dedicated.
- When you don't use for a long time, close the main water supply valve and unplug.
- Do not attempt to repair or modify the power cord at your discretion.
- If the supply cord is damaged, it must be replaced by the manufacturer, its service agent or similarly qualified persons in order to avoid a hazard.
- Do not install near a heating device.
- When the water is coming inside of the product or there is a puddle on the product, call Service Center after closing the supplying valve and unplugging.

-
- If our product produces a strange noise or odd smell, immediately unplug from the electrical outlet and call our Service Center.
 - Do not put the candle, a light for cigarette on the products.
 - Do not place any containers with water, medicine, food, small metallic objects, or any flammable material on the top of the product.
 - Clean after unplugging.

SAFETY INFORMATION

▲ Warning : If not observed, serious injury or property damage could occur.

- If the electric outlet is wet, carefully unplug the unit and let the electric outlet completely dry before subsequent use.
- Unplug the product before repair, inspection, or parts replacement.
- The water cooler is intended to be plugged into a receptacle of the ground fault circuit interrupting type.
- Do not install the product on a sloped floor.
- Do not press the product by constraint or impact.
- Do not clean by spraying the water directly or don't wipe the product using the benzene and thinner.
- Do not repair, disassemble, or modify.
- This appliance can be used by children aged from 8 years and above and persons with reduced physical, sensory or mental capabilities or lack of experience and knowledge if they have been given supervision or instruction concerning use of the appliance in a safe way and understand the hazards involved.
- Children should be supervised to ensure that they do not play with the appliance.
- The new hose-sets supplied with the appliance are to be used and that old hose-sets should not be reused.
- Children shall not play with the appliance.
- Cleaning and user maintenance shall not be made by children without supervision.

//////

⚠ Caution : If not observed, minor physical injury or property damage may occur as a result.

- The filtration device installation shall comply with applicable state and local regulations.
- Use after closing the water tank cover completely inside of the product.
- To drink the filtered water, change the filter according to the filter replacement cycle.
- When you don't use for a long time, use after draining the saved water completely and emptying the newly room water once again.
- Do not allow hot water to come in contact with the human body.
- Do not use filtered water for the water exchange of an aquarium or a fishbowl.
- After moving the product or replacing the Plus Inno-sense filter, the black powder can be remained in the inner bottom of the water tank.
- Do not use with water that is microbiologically unsafe or of unknown quality without adequate disinfection before or after the system.

PARTS NAME

Front

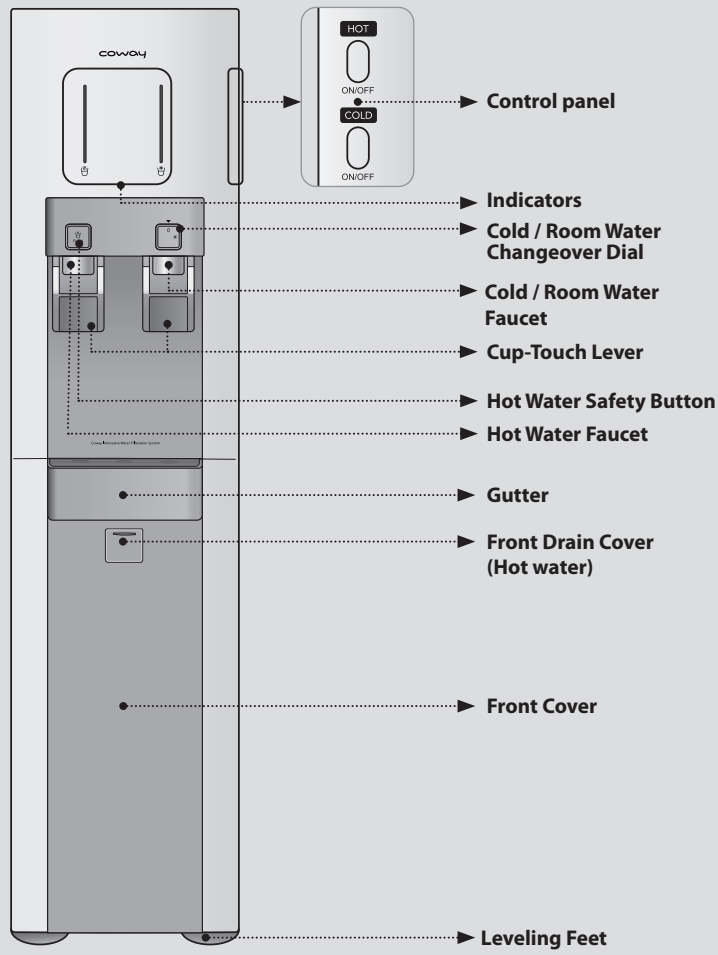

Rear

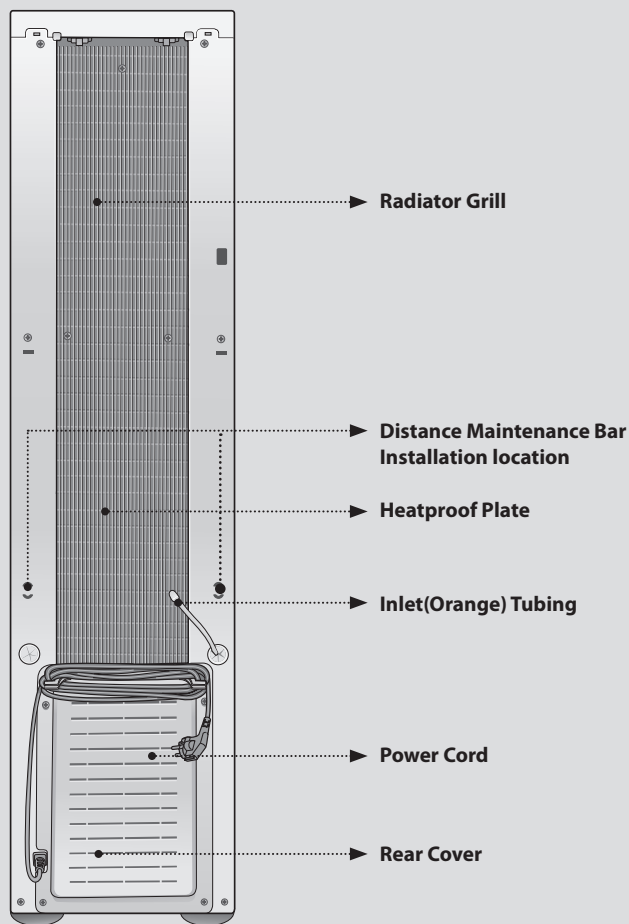

WATER FILTRATION PROCESS

The filter is the core technology of the filtration system.

If you don't use qualifying filter or if you use an old filter that has expired, the system performance may degrade.

The 5-step water filtering system (CHP-590N)

Step 1, 2: NEO-SENSE FILTER

Removes particles such as sand or rust from source water and protects the other filters.
Removes pollutants such as chlorine from the source water.

Step 3 : NANO-TRAP FILTER

Remove particulates in drinking water , It also has the function to remove waterborne microorganisms, bacteria and virus.

Step 4 : PLUS INNO-SENSE FILTER(D)

Removes odorous materials and improves water taste. Fourth filter: Antibacterial filter.
Removes pollutants such as volatile organic compounds(VOCs) from the source water.

Step 5 : ANTIBACTERIAL FILTER*

Prevents microorganisms in the water.

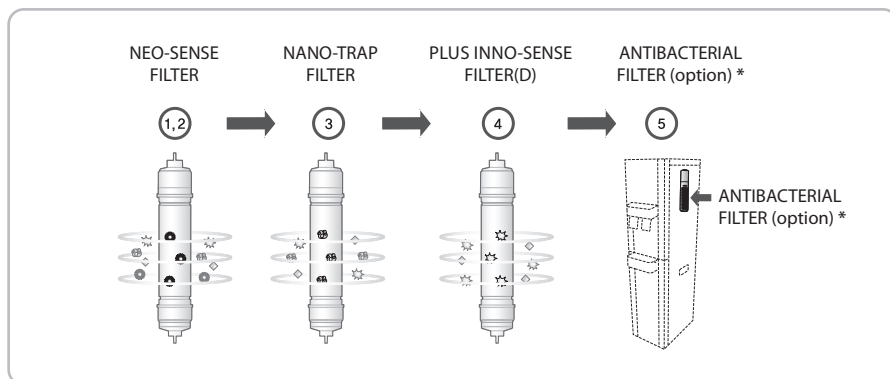

* The Antibacterial filter contains silver, which is known to inhibit the propagation of microorganisms and to maintain the integrity of the filter.

INSTALLATION PRECAUTIONS

The summary for the proper installation of the water filtration device

1. Close main water supply valve to separate the faucet.

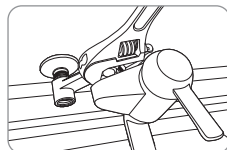

2. Apply the teflon tape on the adaptor and fit it to the pipe.

⚠ Do not turn the water pipe.

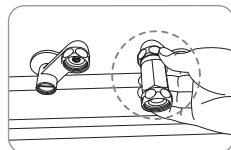

3. Connect the faucet with the adaptor.

⚠ Install the adaptor with connector to the cold water pipe.

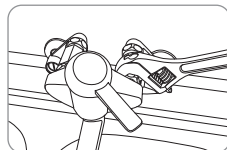

4. Connect 1/4 inch orange tubing with the connector on the adaptor.

⚠ Flush water through each filter at least 5 minutes before Connection.

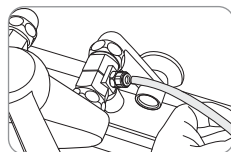

5. Open the feed valve to supply water to the filtration system.

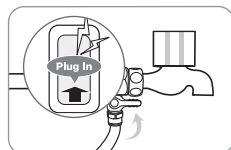

INSTALLATION PRECAUTIONS

Please check before use!



Only connect the power cord to the voltage rating that matches it on the rating plate.



- **After installing the product**

Get rid of the saved water above the full water in the inner water tank 2 times or more to use.

- **When the indicator in the indication part is turned off**

When the indicator in the indication part is turned off, check if the power supply was stopped due to the power failure or other cause.

- **Regular filter replacement**

It is important to replace the filter regularly to maintain water quality as it is designed. If the filter is overused beyond its service life, the performance of the water filtration device deteriorate. Do not miss the filter replacement cycle.

- **When you didn't use for a long time**

If you saved the water for a long time or you didn't use, drain the water inside of the water filtration device completely and remove the newly filtered water one time to use.

- **When you don't want to use the product for a long time.**

Close the main water supply valve and unplug the power cord.

INDICATION / OPERATION PART

Indication part / Operation part

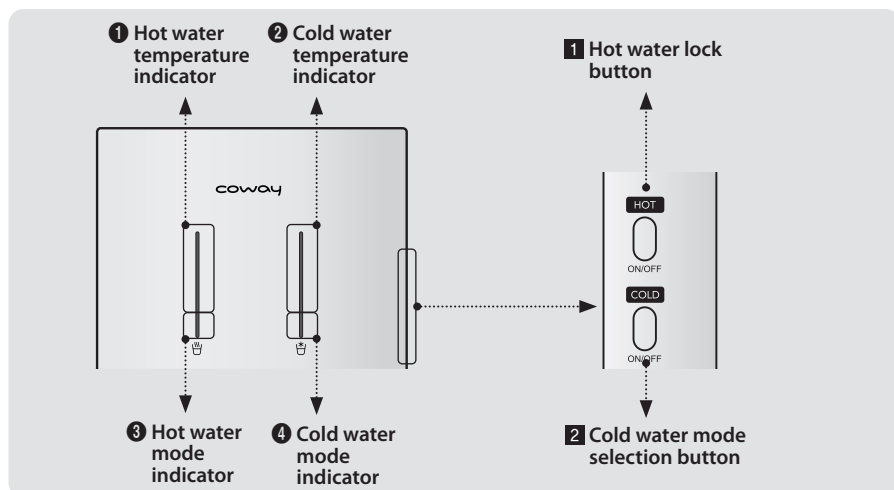

Indication part

1 Hot water temperature indicator

The indicator lights are illuminated according to the temperature of the hot water.
The more light on the indicator, the hotter the water.



2 Cold water temperature indicator

The indicator lights are illuminated according to the temperature of the cold water.
The more light on the indicator, the colder the water.



3 Hot water mode indicator

This indicator is illuminated when Hot Water Mode is selected.



4 Cold water mode indicator

This indicator is illuminated when Cold Water Mode is selected.



INDICATION / OPERATION PART

Indication part

HOT



ON/OFF

1 Hot water mode selection button

To select/deselect hot water mode.

COLD



ON/OFF

2 Cold water mode selection button

To select/deselect cold water mode.

■ To use the Cold Water function

Press the cold water mode selection button and check that the cold water mode indicator light is on. To turn off cold water mode, hold the selection button for about 2 seconds.

* You can dispense cold water about one hour after you turn on the cold water function.

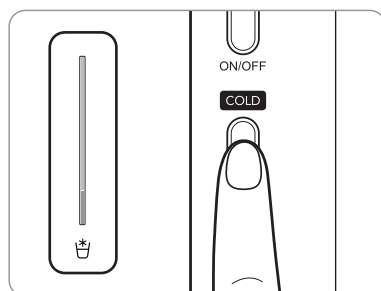

■ To use the Hot Water function

Press the hot water mode selection button and check that the hot water mode indicator light is on. To turn off hot water mode, hold the selection button for about 2 seconds.

* You can dispense hot water about 30 minutes after you turn on the hot water function.

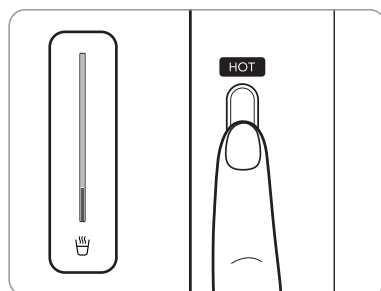

HOW TO USE

To drink the cold water

Turn the cold water conversion knob to the left and push the Cup-Touch Lever to enjoy cold water.

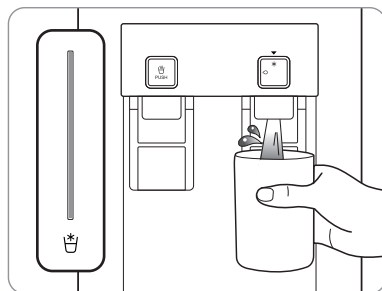
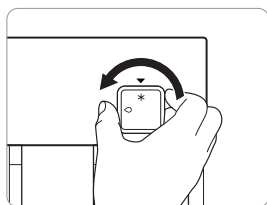

Tips

- If cold water is not dispensed from the water purifier, check that the Cold Water indicator is lit up on the display (see page 13).

To drink the hot water

Press the Hot Water Safety button and push the Cup-Touch Lever to enjoy hot water.

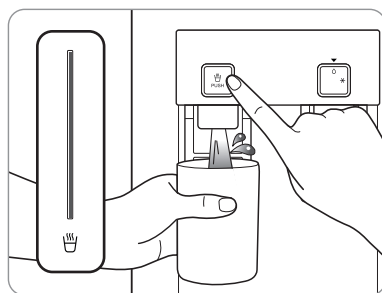
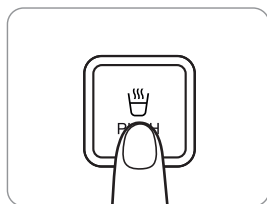

Tips

- If hot water is not dispensed from the water purifier, check that the Hot Water indicator is lit up on the display (see page 13).

HOW TO USE

To drink the room water

Turn the cold water conversion knob to the right and push the Cup-Touch Lever to enjoy room water.

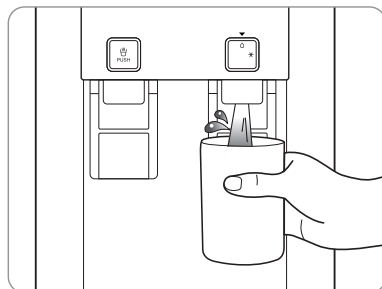
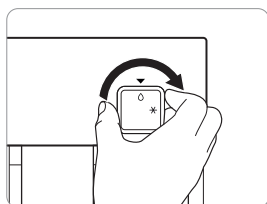

INSTALLATION

Follow the instruction for installation

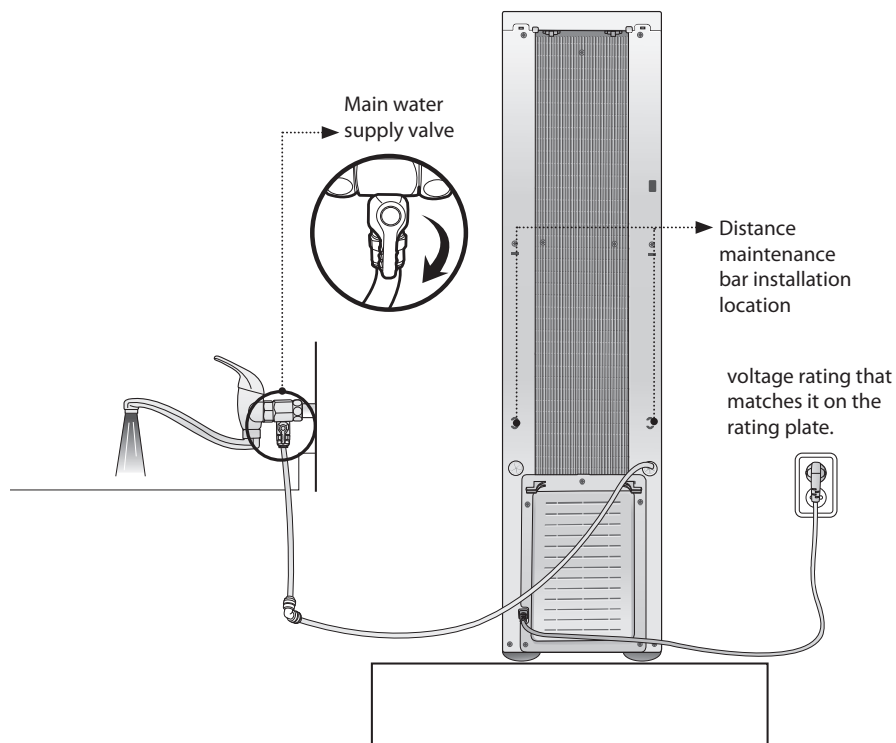

Connect the orange color inlet tubing ① to the tap water supplying pipe.

Inlet tubing (Orange)

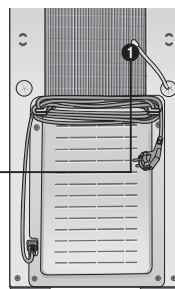

INSTALLATION

Be cautious!

■ Water filtration device installation place 1

Please install the water filtration system not at a rough place, a damp place, a place where the unit is exposed to the direct sunlight, a place where dust is present, or a place that the water drops.



■ Water filtration device installation place 2

Please install at the place where it is 10 cm or more off from the wall and the bottom is flat and firm.

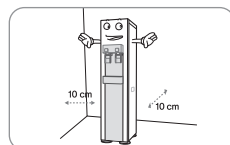

■ After installing the water filtration system

Please empty the water tank filled with filtered water two times after the product installation.

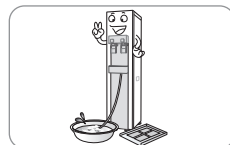

■ Cold water plumbing

Please connect the source water. Make sure that the source water is not from hot water line. If you use hot water as source water, then it will cause permanent damages to filters and severely degrade the product performance.

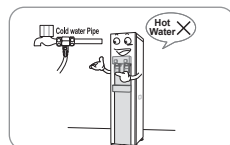

■ Movement and installation

When the position is moved, connect the power cord when 30 minutes passes after installing.

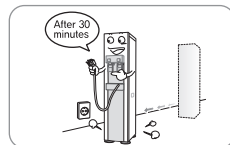

Tips

To maintain optimal product performance, consult a Coway engineer for the detailed installation methods.

- ⚠ There may be some water remaining inside of the filter which was used to test the product during inspection process at the factory. Please feel at easy and use as it isn't the used product.
- ⚠ Don't reuse the main water supply valve and hose that was previously used when you re-install the product.

CLEANING METHOD

Storage tank

1. Hold down both the cold water/hot water function buttons at the front of the product for 2 seconds to turn the product off and then unplug the power cord. Lock the water supply valve.

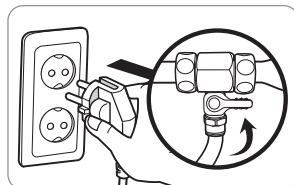

2. Use the outlet tubing to completely drain all water from inside the purifier.

* Drain water from the cold/room water tank from the cold/room water tap and water from the hot water tank from the front drainage outlet.

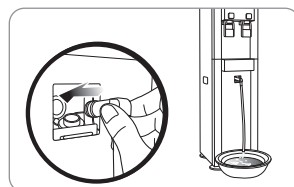
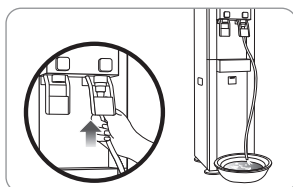

3. Push the upper cover of the product upward to open. Open the clips (x6) affixing the interior storage tank and then remove the hose and open the interior storage tank.

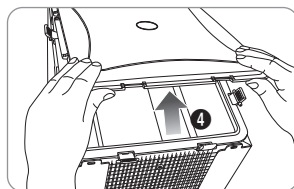
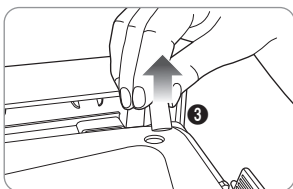
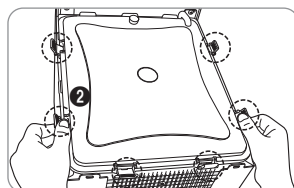
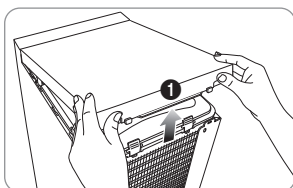

CLEANING METHOD

4. Detach the antibacterial filter from the water tank cover and shake in water from the product to clean, then reinstall.



5. Wipe the interior water tank surfaces with a soft cloth.

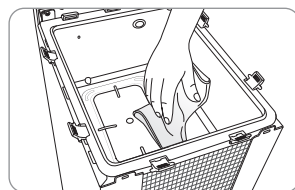

6. Rinse the interior water storage tank clean with water taken in advance from the product, and then use the outlet tubing to completely drain. Run purified water through the product once and empty, and then use.

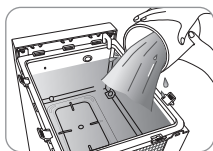

7. Close the upper cover and plug in the power cord, then turn on the water supply valve. Check that water comes from the cold/room temperature and hot water taps and then press the Hot/Cold Water function selection button on the front of the product to restart it.

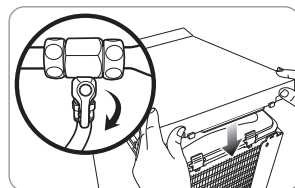

Tips

⚠ **Close the storage tank cover completely.**
Insects or other foreign particles can be entered.

⚠ **When you clean the storage tank, don't use any chemicals or detergent.**
If you don't clean chemicals or detergent cleanly, it can be harmful to the body.
- Keep the surroundings clean and clean the storage tank once per two months.

Drugs,
detergent, etc. X



Gutter

1. Detaching the gutter

Remove the gutter cover and then raise the gutter to easily detach it.

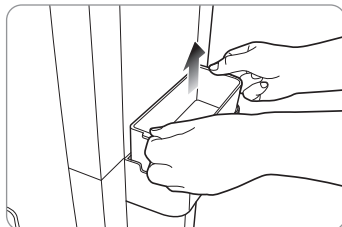
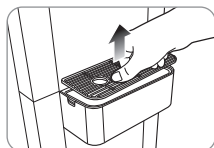

2. How to assemble the gutter

Attach the gutter to the front of the product and then gently lift the gutter cover.

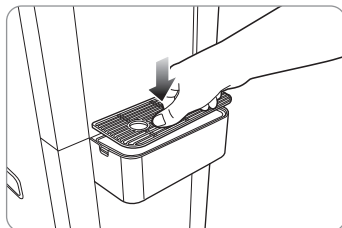

Main body

Wipe with a soft, dry cloth.

- * If there is severe contamination, use a damp cloth (do not use abrasives).

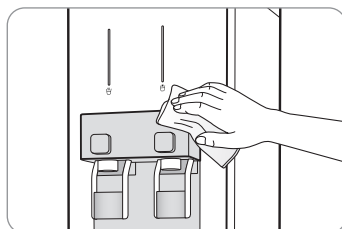

Tips

- Do not immerse the product in water to clean it.
- Do not clean using thinners, benzene, rough cloths, or detergent containing abrasives.

CLEANING METHOD

Faucets

1. Turn the taps in a clockwise direction to detach.

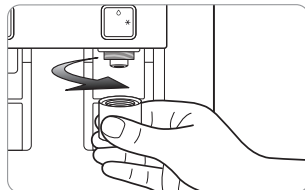

2. Wash the detached taps in running water.

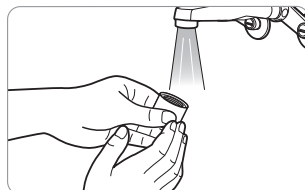

3. Remove moisture from the taps with a soft, dry cloth.

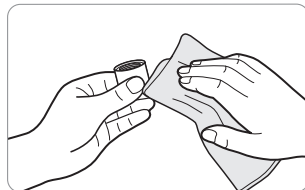

4. After cleaning is finished, turn the taps in a counterclockwise direction to reattach.

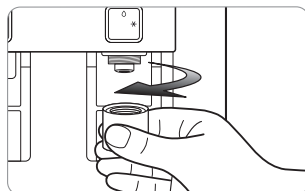

Tips



Never clean using cotton balls.
Bits of cotton or other foreign matter
may remain.

Cup-Touch Lever

Wipe dirty areas of the Cup-Touch Lever with a soft, dry cloth.

* If it is severely contaminated, wipe with a wet cloth.



FILTER REPLACEMENT

■ Filter

Filter is a critical component for a water filtration system. Replacing authorized filters at a specified replacement cycle is important to maintain the water quality, and a proper system operation. Please replace filters at a specified replacement cycle. For replacement filters, please contact Coway authorized dealers and distributors.



■ Filter replacement cycle

If the filter is not regularly replaced, it may degrade the water quality from the product. The source water quality can shorten the filter replacement period.

CHP-590N

Part No.	Names of Filter	Replacement cycle
CNFN14	NEO-SENSE FILTER	6 months
CNTFN14	NANO-TRAP	12 months
CIFN14-D-PLUS	PLUS INNO SENSE(D) FILTER	12 months
CAF-03	ANTIBACTERIAL FILTER (option) *	12 months

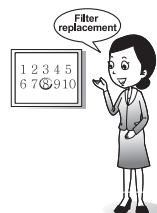

■ About filter replacement cycle

The filter replacement cycle described above is not the filter quality warranty period but the expected cycle (life) that the filter shows its original performance.

Therefore, the filter replacement cycle may be reduced for the area with the poor water quality or more water consumption.



FILTER REPLACEMENT METHOD

1. Close the main water supply valve after unplugging the power cord, and drain the water inside of the water filtration device (See P.18).

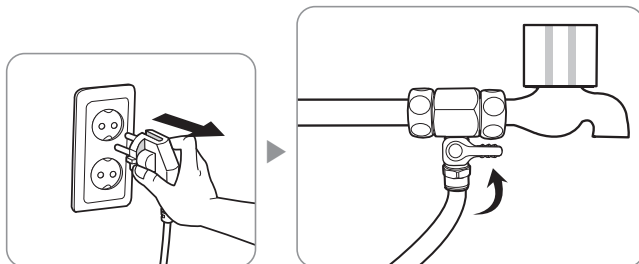

2. After separating the fitting connected to the filter to replace, please replace the filter. (Separate the fitting using the proper tool.)

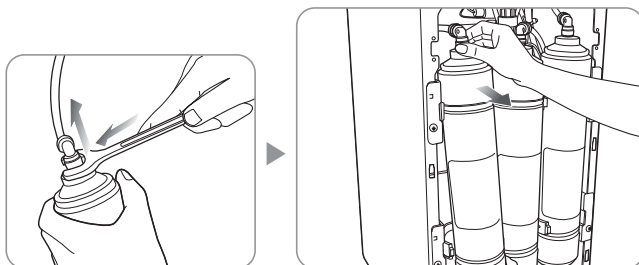

Tips

- ⚠ When you are replacing filters, please make sure that a corresponding filter and a hose are firmly connected and that there is no leakage.
It is recommended to empty the water tank filled with the filtered water at least one time right after the filter replacement.

3. Align the grooves of the front cover to the product and close the cover.



Tips

- ⚠ Use new filters only after washing.
- Neo-Sense filter: Install after washing with source water for about 1 minute.
 - Nanotrap filter: Install after washing with source water for about 3 minutes.
 - Plus Inno-Sense Filter: Install with no separate flushing.
 - Plus Inno-Sense Filter (D): Install with no separate flushing.

TROUBLESHOOTING

The water filtration device may operate abnormally due to minor causes not because of the product malfunction but because of the fact that the user is not familiar with the product use. In such a case, problems can be solved easily even without the help from the Service Center by checking the following items. If you can't solve the problem after checking the following items, please call the Service Center.

Symptom	Check	Measures to take
The water tastes weird.	• Did you clean the storage tank?	Clean the storage tank.
	• You didn't use the water filtration device for a long time.	Get rid of the saved water and clean the storage tank.
	• Isn't it about time to change the filter?	Request the filter replacement.
The water doesn't come.	• Is the water supply cut or isn't the water supply valve closed?	Open the main water supply valve.
	• Did you miss the filter replacement times?	Request the filter replacement.
The water is flowing slower.	• Isn't it about time to change the filter?	Request the filter replacement.
	• Does the main power connect to the voltage rating that matches it on the rating plate?	Connect the power cord to the voltage rating that matches it on the rating plate.
	• Didn't you close the main water supply valve?	Open the main water supply valve.
	• Didn't the temperature of the main water drop suddenly?	If the water temperature is lowered, the water amount is decreased.
The cold water / hot water doesn't come.	• Was the cold water mode indicator lightened?	Please press the cold water mode selection button.
	• Didn't you close the main water supply valve?	If it is the low water level to protect the electric motor, the cooling function doesn't operate. Open the main water supply valve.
	• Isn't the back side of the water filtration device and the wall too close?	Please keep the distance between the back of the water filtration device and the wall to 10 cm or more.
All operation was stopped suddenly when driving.	• Is the main water being supplied actively?	Check the main water supply valve.
	• Does the main power connect to the voltage rating that matches it on the rating plate?	Connect the power cord to the voltage rating that matches it on the rating plate.
	• Isn't water overflowing or leaking?	Request A/S.

SPECIFICATION

Product		Water Filtration Device
Model		CHP-590N
Power Supply		Refer to the rating plate.
Tank Capacity	Room Water	6 L
	Cold Water	3 L
	Hot Water	3 L
	Total	12 L
Dimension		260 mm(W) × 448 mm(D) × 1 150 mm(H)
Working Temperature		5 °C - 35 °C (41 °F - 95 °F)
Production Rate		720 L/d (25 °C, 0.14 Mpa)
Working Pressure		69 kPa – 827 kPa
Net Weight		27 kg

- The water amount can be differentiated according to the water pressure and the water temperature.
- The water tank capacity is the amount by the size and can be different from the extraction capacity.
- Without any prior notice, all or parts of the product are subject to change for the purpose of improving the performance of the product.
- Refer to Performance data sheet for individual contaminants, reduction performance and general operating information.

WATER FLOW DIAGRAM

CHP-590N

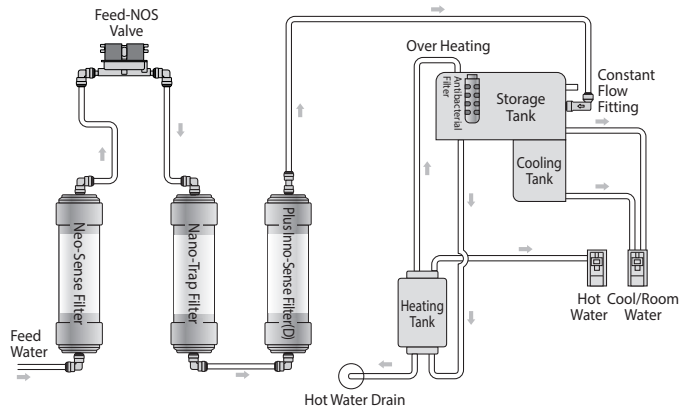

Water Filtration System Performance Data Sheet



Model: CHP-590N

This system has been tested and certified by the Water Quality Association according to NSF/ANSI 42 and 53 for the reduction of the substances listed below and NSF/ANSI 372 for lead-free compliance. The concentration of the indicated substances in water entering the system was reduced to a concentration less than or equal to the permissible limit for water leaving the system, as specified in NSF/ANSI 42 and 53.

Substance	Influent challenge concentration (mg/L unless specified)	Maximum permissible Product water concentration (mg/L unless specified)	Percent reduction (%)
Aesthetic Chlorine	2.00 ± 10%	≥ 50% Reduction	98.0
Particulate, Class I particles 0.5 to < 1 µm	at least 10 000 particles/mL	≥ 85% Reduction	98.5
Turbidity	11 ± 1 NTU	0.5 NTU	99.3
VOCs	3.00 ± 10%	≥ 95% Reduction	99.9

While testing was performed under laboratory conditions, actual performance may vary.

General Operating Information:

Rated Capacity	770 L (for VOC) 20,770 L (for Aesthetic Chlorine)
Min-Max operating pressure:	69 kPa ~ 827 kPa
Min-Max feed water temperature:	5 °C ~ 35 °C
Rated Service Flow	1.89 L/min
Electrical Requirements:	220 V~ 60 Hz

- Do not use with water that is microbiologically unsafe or of unknown quality without adequate disinfection before or after the system.
- Refer to the owners manual for specific installation instructions, manufacturer's limited warranty, user responsibility, and parts and service availability.
- For parts and service availability, please contact your CODY or call center.

Model of Filter	Type
CNFN14	NEO-SENSE FILTER
CNTFN14	NANO-TRAP FILTER
CIFN14-D-PLUS	PLUS INNO SENSE FILTER (D)
CAF-03	ANTIBACTERIAL FILTER **

* Separate labeling in the manual

** The Antibacterial filter contains silver, which is known to inhibit the propagation of microorganisms and to maintain the integrity of the filter.

* VOC Surrogate Claims

Chemical	Influent Challenge Concentration (mg/L unless specified)	Maximum Allowable Product Water Concentration (mg/L unless specified)	Percent Reduction (%)
alachlor	0.050	0.001	> 98
atrazine	0.100	0.003	> 97
benzene	0.081	0.001	> 99
carbofuran	0.190	0.001	> 99
carbon tetrachloride	0.078	0.0018	98
chlorobenzene	0.0775	0.001	> 99
chloropicrin	0.015	0.0002	99
2,4-D	0.110	0.0017	98
dibromochloropropane(DBCP)	0.052	0.00002	> 99
o-dichlorobenzene	0.080	0.001	> 99
p-dichlorobenzene	0.040	0.001	> 98
1,2-dichloroethane	0.088	0.0048	95 ¹
1,1-dichloroethylene	0.083	0.001	> 99
cis-1,2-dichloroethylene	0.170	0.0005	> 99
trans-1,2-dichloroethylene	0.086	0.001	> 99
1,2-dichloropropane	0.080	0.001	> 99
cis-1,3-dichloropropylene	0.079	0.001	> 99
dinoseb	0.170	0.0002	99
endrin	0.053	0.00059	99
ethylbenzene	0.088	0.001	> 99
ethylene dibromide (EDB)	0.044	0.00002	> 99
haloacetonitriles (HAN)			
bromochloroacetonitrile	0.022	0.0005	98
dibromoacetonitrile	0.024	0.0006	98
dichloroacetonitrile	0.0096	0.0002	98
trichloroacetonitrile	0.015	0.0003	98
haloketones (HK):			
1,1-dichloro-2-propanone	0.0072	0.0001	99
1,1,1-trichloro-2-propanone	0.0082	0.0003	96
heptachlor (H-34,Heptox)	0.08	0.0004	> 99
heptachlor epoxide	0.0107 ⁶	0.0002	98
hexachlorobutadiene	0.044	0.001	> 98
hexachlorocyclopentadiene	0.060	0.000002	> 99
lindane	0.055	0.00001	> 99
methoxychlor	0.050	0.0001	> 99
pentachlorophenol	0.096	0.001	> 99
simazine	0.120	0.004	> 97
styrene	0.150	0.0005	> 99
1,1,2,2-tetrachloroethane	0.081	0.001	> 99
tetrachloroethylene	0.081	0.001	> 99
toluene	0.078	0.001	> 99
2,4,5-TP (silvex)	0.270	0.0016	99
tribromoacetic acid	0.042	0.001	> 98
1,2,4-trichlorobenzene	0.160	0.0005	> 99
1,1,1-trichloroethane	0.084	0.0046	95
1,1,2-trichloroethane	0.150	0.0005	> 99
trichloroethylene	0.180	0.0010	> 99
trihalomethanes (includes):			
chloroform (surrogate chemical)			
bromoform			
bromodichloromethane	0.300	0.015	95
chlorodibromomethane			
xylenes (total)	0.070	0.001	> 99

WARRANTY CARD OR WARRANTY LETTER
ONE YEAR LIMITED WARRANTY
WATER FILTRATION DEVICE CHP-590N ("PRODUCT")

Model:

Serial Number:

Customer Name:

("OWNER")

Date of Purchase:

What This Warranty Covers:

Commencing with the date of purchase of the Product and continuing for a period of one year, if manufacturing defects in the Product cause the Product to not operate properly for its intended use, then subject to the exclusions, conditions, and limitations contained herein, COWAY at its sole option will repair or replace the Product.

Decisions as to the extent of repair or replacement required will be made solely by COWAY.

The remedy under this Warranty is available only for that portion of the Product exhibiting defects at the time of the warranty claim. The replacement Product as well as any remaining original Product will be warranted only for the original one year warranty period. This limited warranty applies only to Product used for an application specified by COWAY for the Product and applied in strict accordance with COWAY published specifications in effect at the time of application. IF PRODUCT IS USED FOR OTHER THAN ITS INTENDED PURPOSE, IT IS SOLD AS IS AND WITHOUT ANY EXPRESS OR IMPLIED WARRANTIES, INCLUDING OF MERCHANTABILITY OR FITNESS FOR A PARTICULAR PURPOSE.

What This Warranty Does Not Cover:

This Warranty warrants that the Product will be free from manufacturing defects which affect the ability of the Product to operate for its intended use; it is not a warranty that the Product will never require repairs or to undertake responsibilities, liabilities or obligations other than those specifically identified in the preceding section. COWAY is not responsible or liable for personal injury or property damage of any kind, even if arising from a breach of this Warranty.

Limitations and Exclusions:

TO THE EXTENT PERMITTED BY APPLICABLE LAW, COWAY DISCLAIMS ANY OTHER WARRANTY EXPRESS OR IMPLIED, THAN THAT GUARANTEES FOR HEREIN. THIS WARRANTY IS IN LIEU OF AND EXCLUDES ALL OTHER WARRANTIES, PROVIDES, CONDITIONS AND REPRESENTATIONS, EXPRESS OR IMPLIED, ORAL OR WRITTEN, STATUTORY OR OTHERWISE, INCLUDING BUT NOT LIMITED TO ANY IMPLIED CONDITIONS OR WARRANTIES AS TO THE MERCHANTABILITY OR FITNESS FOR A PARTICULAR PURPOSE OF THE COWAY PRODUCT. SOME STATES DO NOT ALLOW LIMITATIONS ON HOW LONG AN IMPLIED WARRANTY LASTS, SO THE ABOVE LIMITATION MAY NOT APPLY TO YOU. COWAY DOES NOT AUTHORIZE ANY PERSON INCLUDING ITS REPRESENTATIVES, TO MAKE ANY REPRESENTATION OR TO OFFER ANY WARRANTY, CONDITION OR GUARANTY IN RESPECT OF THE PRODUCT OTHER THAN THIS WARRANTY. THIS LIMITED WARRANTY SHALL BE THE OWNER'S SOLE AND EXCLUSIVE REMEDY AGAINST COWAY AND COWAY SHALL NOT BE LIABLE FOR ANY CONSEQUENTIAL, EXEMPLARY, SPECIAL, INCIDENTAL OR OTHER DAMAGES INCLUDING, BUT NOT LIMITED TO, LOSS OF PROFITS, AND LOSS OF USE. INCIDENTAL, CONSEQUENTIAL AND EXEMPLARY DAMAGES SHALL NOT BE RECOVERABLE EVEN IF THE REMEDIES OR THE ACTIONS PROVIDED FOR IN THIS WARRANTY FAIL OF THEIR ESSENTIAL PURPOSE. SOME STATES DO NOT ALLOW THE EXCLUSION OR LIMITATION OF INCIDENTAL OR CONSEQUENTIAL DAMAGES, SO THE ABOVE LIMITATION OR EXCLUSION MAY NOT APPLY TO YOU. COWAY SHALL NOT BE LIABLE FOR ANY DAMAGES WHICH ARE BASED UPON NEGLIGENCE, BREACH OF WARRANTY, STRICT LIABILITY OR ANY OTHER LEGAL THEORY OF LIABILITY OTHER THAN THE EXCLUSIVE LIABILITY SET FORTH IN THIS WARRANTY

Limitations on Implied Warranties:

Any implied warranty of merchantability or fitness for a particular purpose or use, shall be limited to the duration of the foregoing express written warranty.

Conditions of Warranty:

COWAY's continuing liability under this Warranty is conditioned upon the following :

- a) The defect or damage is not caused by or is the result of : abnormal use or conditions; improper storage, unauthorized modifications or repair; misuse, neglect, accident, alteration, improper installation or other acts that are not the fault of Coway or the manufacturer of the product or that are not covered by the manufacturer's warranty;
- b) The Product has not been altered, modified or repaired without prior written approval of COWAY;
- c) The OWNER has notified COWAY in writing of any failure of the Product covered by this Warranty within thirty (30) days following such failure;

- d) There has been no misuse, abuse or negligence with respect to the Product on the part of the OWNER.

Waiver:

COWAY's failure at any time to enforce or rely upon any of the terms or conditions stated herein shall not be construed to be a waiver of its rights hereunder.

Obtaining Warranty Service and OWNER'S Duties:

If the Product fails to operate for its intended purpose, then notify Coway or its Representative Agency within 48 hours or within the next business day after discovery of any defect in the Product. The OWNER must give written notice to COWAY no later than thirty (30) days after a defect is discovered or should by reasonable diligence have been discovered. Claims under this Warranty will require proof of purchase by the OWNER.

KOREA

Add : COWAY Co., Ltd.
136-23, Yugumagoksa-ro, Yugu-eup, Gongju-si,
Chungcheongnam-do, 32508 Korea
Tel. : 041-850-7879

USA

Add : Coway USA, Inc.
4221 Wilshire Blvd. #210, Los Angeles, CA 90010
Call center. : 213-386-3033

THAILAND

Add : Coway (Thailand) Co., Ltd.
75/104-106 Ocean Tower 2 38th Fl, Soi Sukhumvit
19 (Wattana), Sukhumvit Road, Klongtoey Nua,
Wattana, Bangkok 10110
Call center : 1421

MALAYSIA

Add: Coway (Malaysia) Sdn. Bhd.
Level 20, Ilham Tower, No. 8, Jalan Binjai, 50450 Kuala
Lumpur.
Call center : 1-800-888-111

coway

www.coway.com