

Coway Water Purifier User's Manual P-6320R

This product cannot be used if the voltage is different from that mentioned in the rating plate.
For your safety and proper use of the product, please read this User's Manual before use.

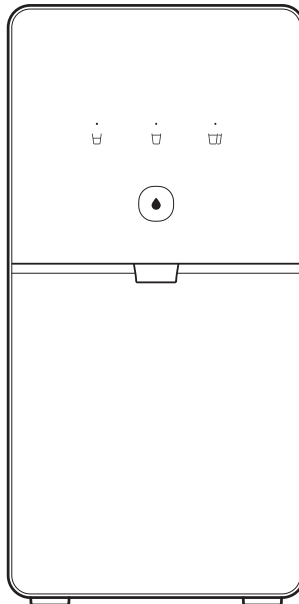

FEATURES

| Clean and tasty water

Coway's outstanding Intensive RO Filter System provides clean and better-tasting water.

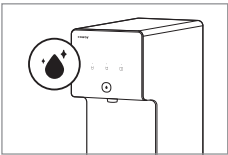

| Space saving slim design

Slim design makes it a perfect fit for kitchen counters.

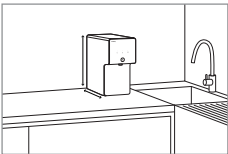

| Automatic dispensing mode

You can choose the preferred water volume with just one touch.

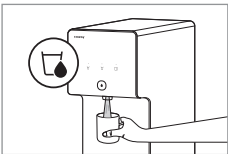

| Easy filter replacement

Easy filter replacement without additional equipment makes your filter maintenance easier.

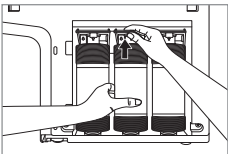

| Hygienic airtight water tank

It is hygienic by applying a separate airtight structure to the water tank to prevent secondary contamination caused by the penetration of dust, insects, and other foreign substances.

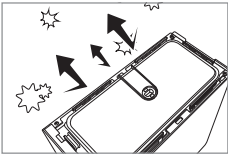

| Fine particle filtering system

The Plus Inno-Sense filter filters out fine dust once more, making the water tank more hygienic.

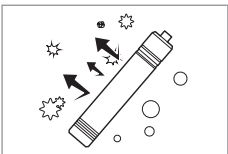

Thank you for using **Coway Water Purifier**.
Please read this User's Manual carefully for correct use and maintenance of the product.
You can refer to the User's Manual to troubleshoot for product issues while using it.
Please keep this User's Manual in a safe place.

| Contents

Product information	How to use
03 Safety information	09 Check before use
Power	10 Hygienic method of use
Installation	11 How to install
During use	13 Buttons and indicators
Others	14 How to get the desired water
07 Part names	How to get ambient water
08 Water purification process	
Maintenance	Other
15 How to clean	21 Troubleshooting
How to clean the water tank	22 Specification
How to clean the main body	23 Water flow diagram
How to clean faucet	
19 Filter replacement	
20 How to replace filter	

SAFETY INFORMATION

Please follow all the instructions for your safety!

These instructions are to keep you safe and to prevent property damage. Please use the product correctly after carefully reading the precautions.



Danger

Death or serious injury may occur if the instruction is not followed.



Warning

Severe injury or property damage may occur if the instruction is not followed.



Caution

Minor bodily or property damage may occur if the instruction is not followed.

| Power

- ⚠ Do not use a damaged power adapter or loose socket.**
There is a risk of electric shock or fire.
- ⚠ Do not pull on the power adapter.**
There is a risk of electric shock or fire.
- ⚠ Do not pull on the power adapter to move the product.**
There is a risk of electric shock or fire.
- ⚠ Do not touch the power adapter with wet hands.**
There is a risk of electric shock or fire.
- ⚠ Do not bend the power adapter excessively or put it under a heavy object to avoid damage or deformation.**
There is a risk of electric shock or fire.
- ⚠ Do not connect and disconnect the power adapter repeatedly.**
There is a risk of electric shock or fire.
- ⚠ If water got into the power supply section, then disconnect the power adapter and completely dry it before use.**
There is a risk of electric shock or fire.
- ⚠ Make sure the product is unplugged while the product is being repaired, inspected, or when its parts are being replaced.**
There is a risk of electric shock or fire.
- ⚠ Remove any dust or water off the pin and contacts of the power adapter.**
There is a risk of electric shock or fire.

- ⚠ **Do not connect multiple products to one power outlet. Use a separate socket for the product.**

There is a risk of electric shock or fire.

- ⚠ **If you don't use it for a long time, then close the tap water supply valve and disconnect the power adapter.**

There is a risk of electric shock or fire.

- ⚠ **Do not arbitrarily connect or modify the power adapter.**

There is a risk of electric shock or fire.

- ⚠ **If the power adapter is damaged, do not attempt to replace the adapter. Instead, contact the service center to replace it.**

There is a risk of electric shock or fire.

- ⚠ **Once the product is connected to power, the pump is operated automatically until the water tank gets full. (In case of water cut-off, remove the power plug.)**

| Installation

- ⚠ **Do not install the product close to any heat sources.**

There is a risk of electric shock or fire.

- ⚠ **Do not install the product on a sloped floor.**

There is risk of bodily harm and product damage.

- ⚠ **Do not apply excessive force or impact to the product.**

There is risk of bodily harm and product damage.

- ⚠ **Any use and/or installation of the water purifier must conform to local regulations.**

SAFETY INFORMATION

Please follow all the instructions for your safety!

These instructions are to keep you safe and to prevent property damage. Please use the product correctly after carefully reading the precautions.



Danger

Death or serious injury may occur if the instruction is not followed.



Warning

Severe injury or property damage may occur if the instruction is not followed.



Caution

Minor bodily or property damage may occur if the instruction is not followed.

| During use

- ⚠ Please lock the tap water valve and disconnect the power adapter and contact the service center if there is water leakage from inside the product or if water is puddling around the product.**
There is a risk of electric shock.
- ⚠ Do not place candles or cigarettes on top of the product.**
There is a risk of fire.
- ⚠ Do not place a bowl filled with water, medicine, food, small metallic objects, or any flammable materials on the product.**
There is a risk of electric shock, fire, and product damage if such substances seep into the product.
- ⚠ Please replace the filter according to the filter replacement cycle for clean water.**
Using the expired filter decreases water purification performance.
- ⚠ Close the water tank cover inside completely before use.**
Bugs and debris may enter the product.
- ⚠ Drain the stored water as well as newly filtered water one more time completely prior to use when not using the product for an extended period of time.**
The stored water may be contaminated.
- ⚠ Anyone who has insufficient physical, sensory or mental ability (including children) must be supervised or instructed to use the product.**
There is a risk of bodily damage or product breakage.
- ⚠ Children should be supervised to ensure that they do not play with the appliance.**
There is a risk of bodily damage or product breakage.
- ⚠ Make sure to use the new hose set provided with the product. Do not use an old hose set.**

| Others

- ⚠ Do not directly spray water on product for cleaning or use benzene or thinner to wipe the product.**
There is a risk of electric shock or fire.
- ⚠ Do not arbitrarily open, repair, or remodel the product.**
There is risk of electrocution and product damage.
- ⚠ Do not use the filtered water for replacing water in fish tanks and aquariums.**
Water filtered through the membrane does not contain ion substances, which may be inappropriate for fish. There is a risk of fish mortality depending on the circumstances.
- ⚠ Move the product according to the prescribed method and do not lift or move the product carelessly.**
This causes water leak and product damage.
- ⚠ Do not drink or use unsterilized water without proper decontamination before or after using the product.**

PART NAMES

| Front/Rear

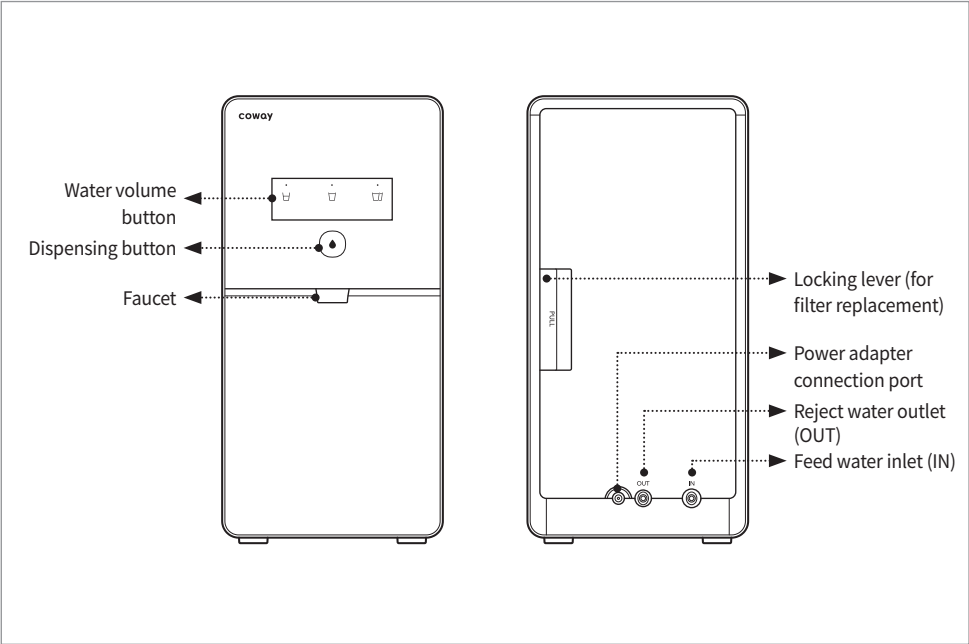

| Accessories

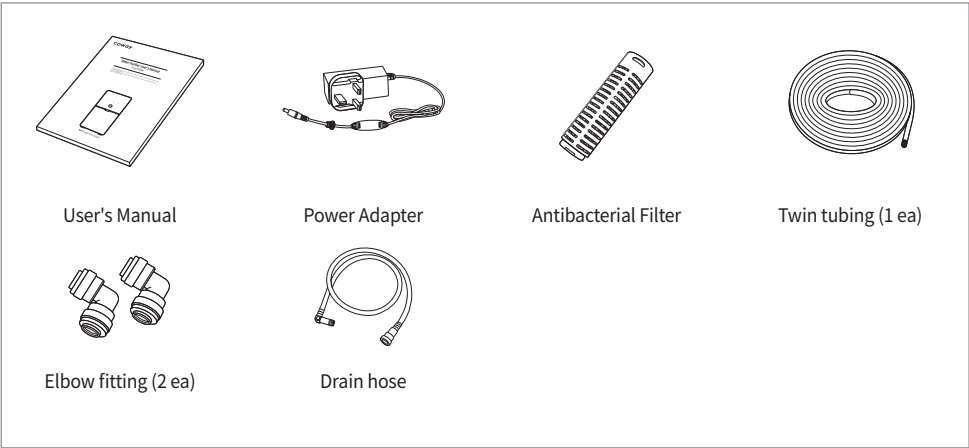

The filter is the most important part of a water purifier.

If you use a non-authentic filter or use an authentic filter too long, then the overall performance of the water purifier may decrease.

5-Step Water Purification System (P-6320R)

1st filter: Plus Neo-Sense filter

- Step 1: It removes particulate materials, sediments, rust, dirt, sand and all other similar impurities.
- Step 2: It removes excess chlorine, bad odor, organic impurities and protects the membrane filter (RO).

2nd filter: Membrane filter (RO)

- Step 3: It removes pollutants such as heavy metal, microorganisms, organics materials and mineral ions.
Water condensed with pollutants will be drained out of the reject water drain hose.

3rd filter: Plus Inno-Sense filter

- Step 4: It improves the water's taste by removing odor-causing substances, soluble pollutants, chlorine, and volatile organic compounds.

4th filter: Antibacterial filter

- Step 5: It inhibits microorganism development.

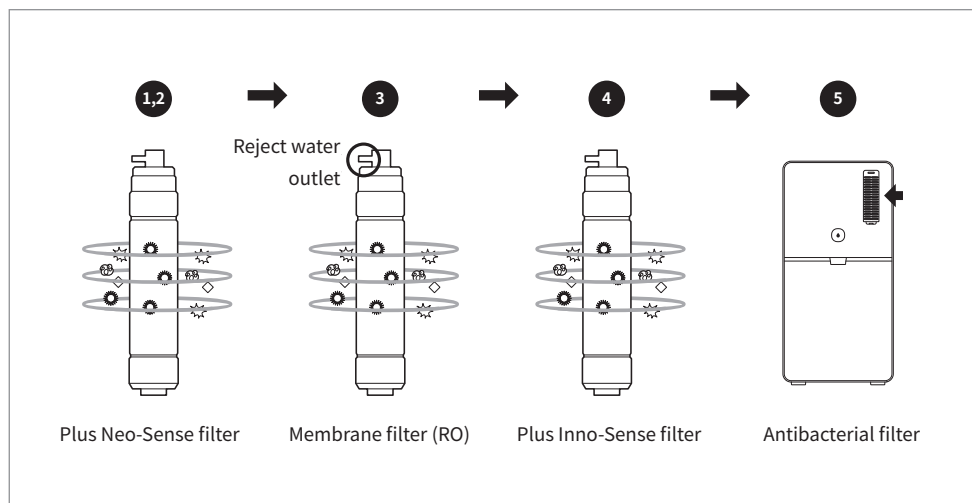

Tips

► Uses of reject water

- Reject water can be used for cleaning the bathroom, around the house, washing clothes, or purposes other than drinking.
- Never use the reject water for drinking or cooking.

CHECK BEFORE USE

| Please check before use!

▲ This product is for 24 V .

Make sure to connect the power adapter to a 24 V  outlet.
It requires a power supply to operate.

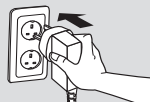

| Connecting Power Adapter

Before using the water purifier, connect the power adapter to the port on the bottom rear of the product.

* Caution

- Slide the power adapter all the way in until it clicks into place
- The product will not work if you do not slide the power adapter all the way in.
- Make sure that no damage is caused to the adapter
- Do not use a damaged adapter. Follow instructions to avoid electric shock or fire.

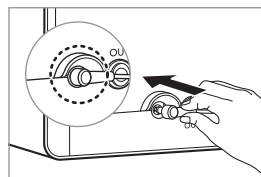

| Open the tap water supply valve.

Tap water must be supplied for operation.

| When the indicator in the indication part turns off

Please check if the power supply was shut off due to power failure or other causes.

| When the product has not been used for a long time

If the appliance is stored or not used for a long time, completely drain the stored water as well as newly filtered water before using the appliance.

| After installing the product

Wait until the tank gets filled up with newly purified water for about 50 minutes or longer, and then drain the water completely.

| Regular filter replacement

It is very important to replace the filter periodically in order to drink clean water. Using an expired filter may result in the change in water taste and degraded filtration function, so be sure to replace the filter on time.

| Suggestion for energy saving

If the appliance is not used for a long period, close the main(tap) water supply valve then drain the remaining water completely and unplug the power adapter.

Main Category	Sub Category	Action
Period of use	When not using the product for longer than 3 days	<ul style="list-style-type: none"> When not using the product for longer than 3 days, throw away the stored water. When re-using, fill up the water once and throw it away before use.
How to use	Dispensing hole contamination	<ul style="list-style-type: none"> Keep hands and mouth away from the dispensing holes and avoid having the cups customers used come into contact with the part. Self care - Wipe the dispensing holes with a clean, dry cloth/non-woven cloth (once a week).
	When receiving water	<ul style="list-style-type: none"> Make sure that beverage (coffee, tea, soda) or food splash does not get inside of the dispensing holes or on the front cover of the product. If the product comes in contact with beverages or other foreign matters, wipe them off immediately to prevent further contamination.
	Water tray and residual water tank	<ul style="list-style-type: none"> Do not throw away coffee, drinks, or food other than residual water into the tray. Do not leave the residual water in the water tray for more than one day. Clean once a week for self care.
	Product disassembly	<ul style="list-style-type: none"> Do not disassemble or open the product arbitrarily.
	Use products	<ul style="list-style-type: none"> Do not place anything on the product (it may spill contaminants).
	Filter	<ul style="list-style-type: none"> Do not use filters other than Coway genuine filters.
Management	Hardware	
	Management check	<ul style="list-style-type: none"> Receive our regular maintenance check service for a water purifier. * The maintenance check period may vary by product.
	Filter replacement intervals	<ul style="list-style-type: none"> Get a filter replacement and maintenance check in accordance with the designated filter replacement time for each filter.
	Management authority	<ul style="list-style-type: none"> Our water purifier is managed by Coway Cody and service managers. When non-specialists replace or clean internal parts of our product, there may be a risk of water leakage, so please ask our Cody and service managers for service.
	Management card records	<ul style="list-style-type: none"> If inspection, cleaning, and parts replacement are performed during servicing, the contents should be recorded on the management card and confirmed.
Product installation	Surroundings	<ul style="list-style-type: none"> Make sure that the area around the water purifier is kept in sanitary conditions at all times including proper distance from a recycle bin.
	Product disassembly and installation of the product	<ul style="list-style-type: none"> Do not disassemble or install the product arbitrarily; have our service managers perform such tasks.
	Installation environment	<ul style="list-style-type: none"> Do not install in an environment where the product is likely to be contaminated. <ul style="list-style-type: none"> - In the toilet, places with many rats and pests (e.g. ants, cockroaches) and places with poor sanitation management and severe contamination (e.g. ships, rivers, livestock, wastewater, etc) - Extreme humidity or salty seawater areas - Places with exposure to direct sunlight - Other unsanitary environment judged to be inappropriate for water purifier installation
	Installation conditions	<ul style="list-style-type: none"> Install R type product or L type product with the booster pump in hard water areas (underground water, etc)

HOW TO INSTALL

| Installation guide

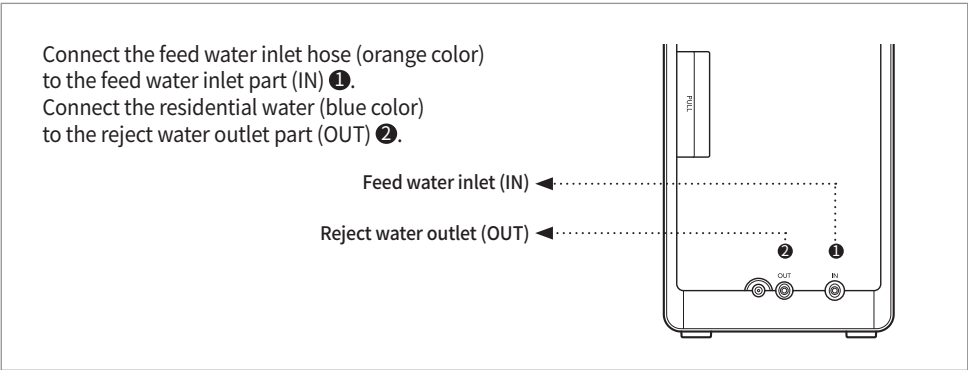
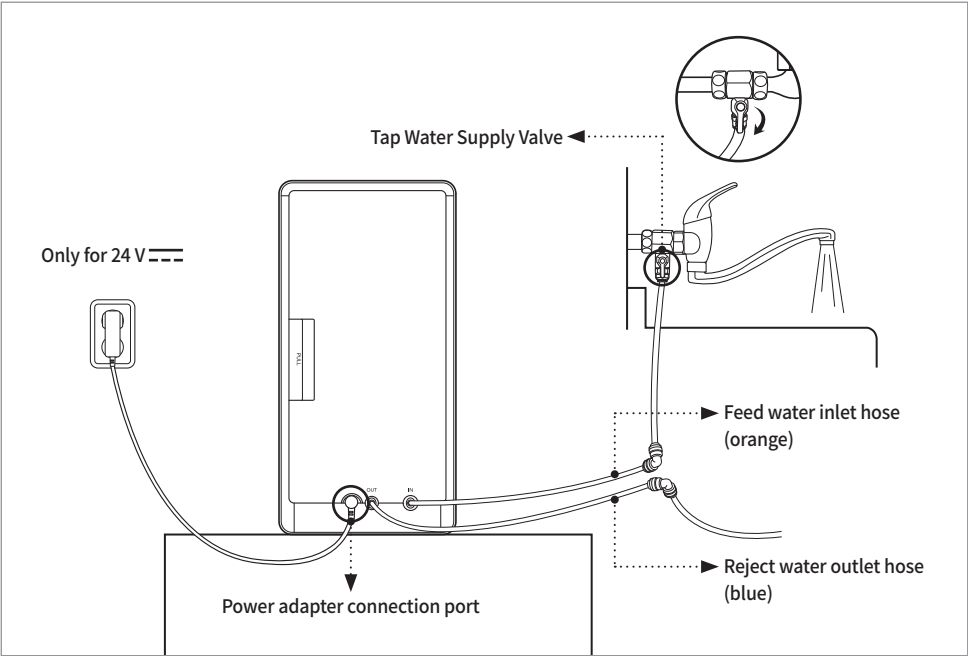

| Caution!

▲ Installation Location I

Avoid installing the water purifier in an area with uneven surface, extreme humidity, extreme light exposure, extreme dust exposure, and water exposure, etc.

▲ Installation Location II

Keep the radiator grill at the rear of the product at least 5 cm away from the wall and make sure that the installation floor is firm.

▲ Connect To Cold Water Supply Only

Make sure to connect it to the cold water supply (If connected to hot water, the filters will be damaged and may not be used.)

▲ After Installation

Wait until the tank gets filled up with newly purified water for about 1~2 hours or longer, and then drain the water completely (repeat it at least twice.)

BUTTONS AND INDICATORS

| Buttons / Indicators

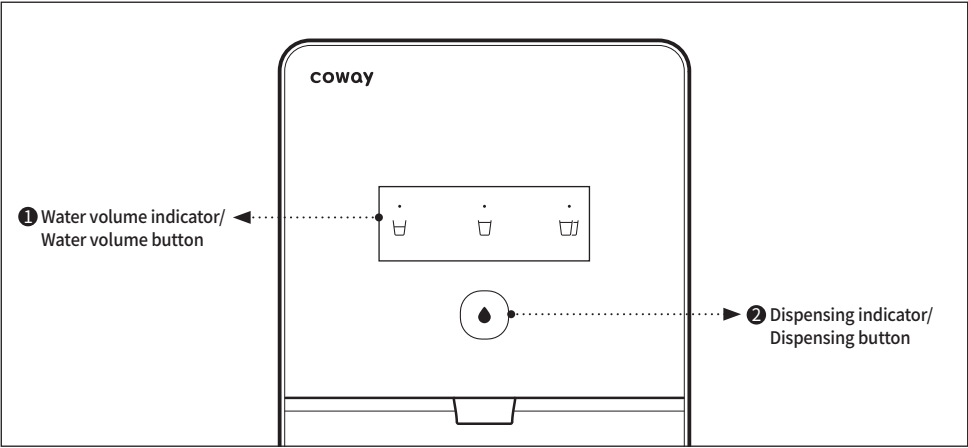

**1 Water volume indicator/
Water volume button**
It indicates the selected water volume.
Press the button to choose the desired
water volume to dispense.



**2 Dispensing indicator/
Dispensing button**
The indicator turns on when dispensing
function is operated.
Press the button to dispense water.

| How to get ambient water

Press the dispensing button, once you have the desired amount, press the button again to stop.

- To use automatic dispensing mode

Touch the water volume icon to select the desired water volume.
Each time you touch the icon, the water volume changes in the order of half cup → one cup → two cups.

Press the dispensing button, then the selected amount of water will dispense.

If you press the dispensing button again during dispensing, it will stop.

- * Half cup -approximately 250ml, One cup- approximately 500ml, Two cup - approximately 1000ml.
- * The initial setting is half cup. If you want to change the default setting, press the water volume button for the desired amount for 3 seconds.
- * The volume of dispensed water may vary depending on the installation environment.
- * It may come out less than the usual amount if the amount of water in the water tank is insufficient.

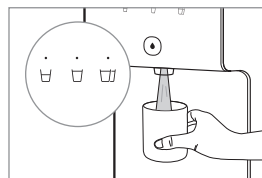

- To use continuous dispensing mode

Press the dispensing button for 2 seconds or longer, the water will dispense continuously for about 3 minutes.

If you press the dispensing button again during dispensing, it will stop.

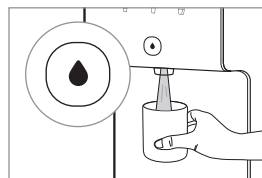

HOW TO CLEAN

| How to clean the water tank

1. After closing the tap water supply valve, connect the drain hose to the faucet. Place an empty bucket (more than 5L) under the faucet and put the drain hose in a bucket. Press and hold the dispensing button for 2 seconds or longer to conduct continuous dispensing, and unplug the power adapter after finishing the drain.

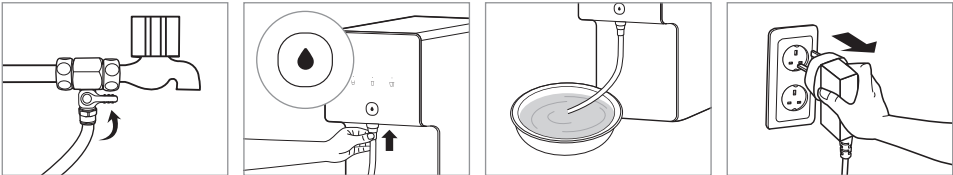

2. Slide the top cover back to open, unlock the locking tabs (5) on the water tank and open the water tank cover.

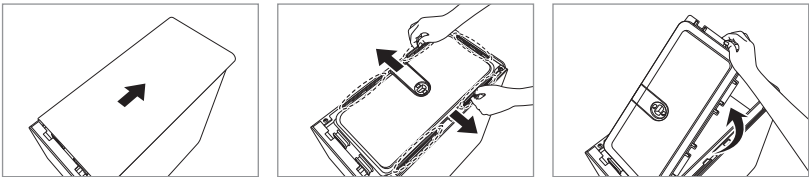

3. Separate the fresh kit from the cover of water tank and shake & rinse it out with clean water before putting it back in.

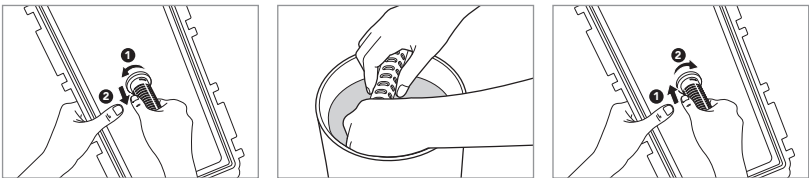

4. Wipe the surface of the water tank with a soft cloth.

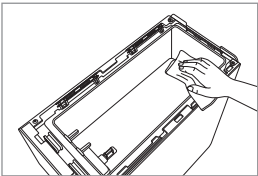

5. Rinse the water tank with the purified water drained from this appliance.
Then plug in the power adapter to drain the remaining water completely.
(After completely draining water, use it after emptying with newly dispensed water at least once.)

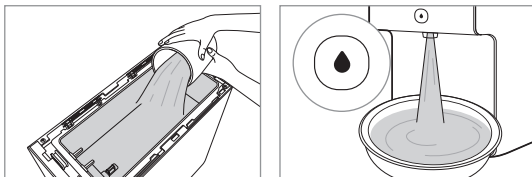

6. Close the water tank cover and assemble the fixing tabs.

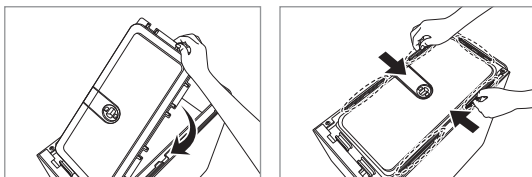

7. Close the top cover and open the tap water supply valve.

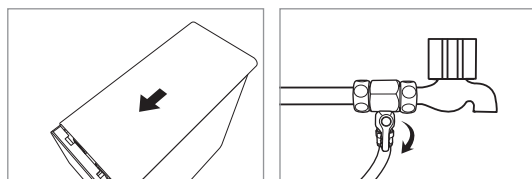

Tips

- ⚠ Please make sure that all covers of the product completely, otherwise, insect or other foreign substance may get in.
- ⚠ Do not use chemical or detergent for cleaning the water tank. If chemical or detergent is not washed away completely, it can be harmful to the human body.
- Please keep the surrounding environment clean, and wash the water tank once every two months.

HOW TO CLEAN

| How to clean the main body

Use a dry and soft cloth to wipe it off.

* If the area needs more cleaning, wet a cloth slightly and wipe it off. (Do not use an abrasive.)

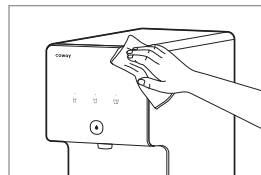

Tips

- Do not spray water directly to the product to clean it.
- Do not use thinner, benzene or agent containing abrasives or rough cloths to clean it.

| How to clean faucet

1. Turn the faucet clockwise to separate it.

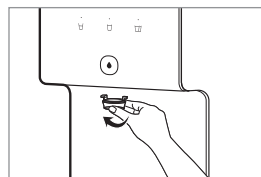

2. Wash the separated faucet in the running water.

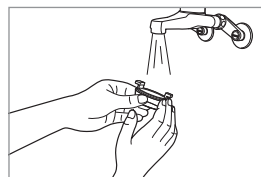

3. Clean the faucet with a soft, dry cloth.

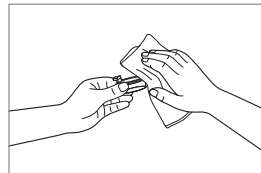

4. When cleaning is complete, turn the faucet counterclockwise until it clicks to assemble it again.

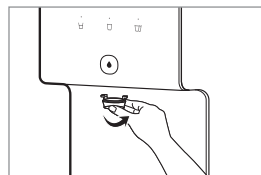

Tips

- ⚠ Never use a cotton swab to clean it.
Foreign objects such as cotton swabs may not be removed completely.

FILTER REPLACEMENT

| Filter

The filter is the most important part of a water purifier. If you use a non-authentic filter or use an authentic filter too long, then the overall performance of the water purifier may decrease. Replace it with an genuine filter according to its replacement period. Please contact the service center for more information.

| Filter replacement cycle

If you do not replace the filters regularly, the quality of water from the product may decrease. The expected filter replacement cycle can vary depending on the feed water characteristics or the amount of purified water used.

P-6320R

Filter name	Expected Replacement Cycle
Plus Neo-sense filter	6 months
Membrane filter (RO)	24 months
Plus Inno-sense filter	18 months
Antibacterial filter	12 months

| About filter replacement cycle

Expected filter replacement cycle can be properly estimated based the quality and conditions of faucet water. For reference, the effective water capacity means the minimum treatment capacity for which contaminants can be effectively removed without cleaning, recycling, or replacing the inner filters, and recommended replacement cycles for individual filters may differ. Filter replacement cycle may vary depending on the operating environment. (the amount used, region of use, season, and water quality.)

HOW TO REPLACE FILTER

Maintenance

| Replace the Filter!

1. Close the tap water supply valve, drain the water inside the water purifier completely, and unplug the power adapter.

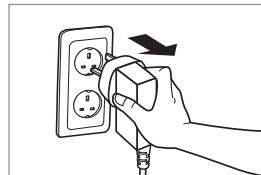
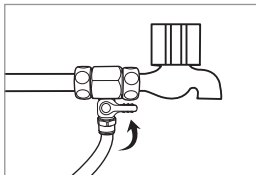

2. Pull the filter replacement lever on the right rear side of the product and slide the side cover backward to separate it.

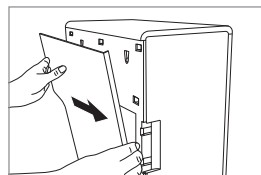
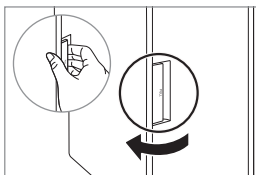

3. Hold the lower part of the filter to be replaced with one hand and raise the tightened lock lever upward to replace the filter.

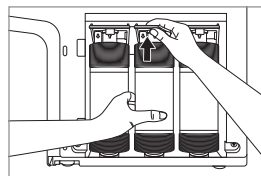
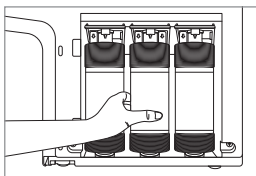

4. After replacing the filter, fit the hooks and slide the side cover forward from back to tighten it.

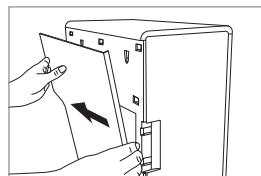
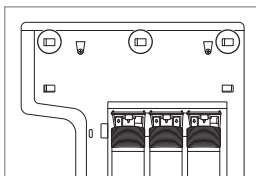

 A new filter must be rinsed out before use.



Tips

- Plus Neo-Sense filter: Assemble after flushing it for about 1 minute.
- Plus Inno-Sense filter: Assemble it without additional washing.
- Membrane filter (RO): Install a reject water valve, and flush it for about 5 minutes before assembly.



Tips

After using the fittings, tubings or water faucet for more than five years, contact the service center to get a replacement.
(A user may be charged for replacement service.)

TROUBLESHOOTING

The water purifier may operate abnormally due to minor causes not because of the product malfunction but because of the fact that the user is not familiar with the product use. In such a case, problems can be solved easily even without the help from the Service Center by checking the following items. If you can't solve the problem after checking the following items, please call the Service Center.

Symptom	Checkpoints	Solution
The water tastes weird.	• Did you clean the storage tank?	Clean the storage tank.
	• You didn't use the water purifier for a long time.	Get rid of the saved water and clean the storage tank.
	• Isn't it about time to change the filter?	Request the filter replacement.
The water doesn't come.	• Is the water supply cut or isn't the water supply valve closed?	Open the main water supply valve.
	• Did you miss the filter replacement times?	Request the filter replacement.
The water is flowing slower.	• Isn't it about time to change the filter?	Request the filter replacement.
	• Does the main power connect to the voltage rating that matches it on the rating plate?	Connect the power adapter to the voltage rating that matches it on the rating plate.
	• Didn't you close the main water supply valve?	Open the main water supply valve.
	• Didn't the temperature of the main water drop suddenly?	If the water temperature is lowered, the water amount is decreased.
A leakage occurred.	• Doesn't the water inside of the storage tank cover or the water purifier flow out?	Check by opening the upper cover and request the service after closing the main water valve.

Product Name	Coway Water Purifier
Model Name	P-6320R
Water Purification Type	Reverse osmosis type
Rated Voltage	24 V 
Tank Capacity	5 L
Rated input	20 W
Product Size	200 mm (width) × 400 mm (depth) × 405 mm (height)
Tap Water Temperature	5 °C - 35 °C
Working Temperature	5 °C - 35 °C
Working Pressure	0.05 MPa – 0.83 MPa
Product Weight	6.5 kg

- The tank capacity refers to the size of water tank and may differ from the amount of dispensed water.
- The product design and specification can be changed without prior notice to improve the product quality.
- The recovery rate means the ratio of output water quantity to input water quantity. It can vary depending on the water pressure/temperature/quality at the installation location.

KOREA
Add : COWAY Co., Ltd. 136-23, Yugumagoksa-ro, Yugu-eup, Gongju-si, Chungcheongnam-do, 32508 Korea Tel. : 041-850-7879

USA
Add : Coway USA, Inc. 4221 Wilshire Blvd. #210, Los Angeles, CA 90010 Call center : 213-386-3033

THAILAND
Add : Coway (Thailand) Co., Ltd. 75/104-106 Ocean Tower 2 38th Fl, Soi Sukhumvit 19 (Wattana), Sukhumvit Road, Klongtoey Nua, Wattana, Bangkok 10110 Call center : 02-261-0209

MALAYSIA
Add: Coway (Malaysia) Sdn. Bhd. Level 20, Ilham Tower, No. 8, Jalan Binjai, 50450 Kuala Lumpur. Call center : 1-800-888-111

INDONESIA
Add : PT Coway International Indonesia Sequis Tower, Lantai 17, Jalan Jenderal Sudirman Kaveling 71, Kel. Senayan, Kec. Kebayoran Baru, Kota Adm. Jakarta Selatan, Prov. DKI Jakarta Call center : 021-5086-0416

VIETNAM
Add: 9th Floor, Peakview Tower, 36 Hoang Cau Street, O Cho Dua Ward, Dong Da District, Hanoi City, Vietnam Call center : 1800 556892

WATER FLOW DIAGRAM

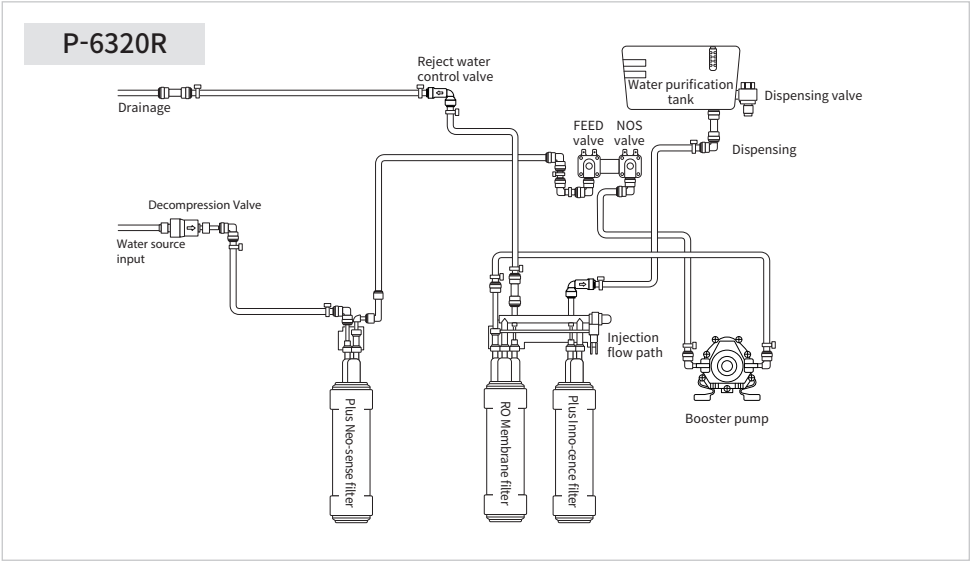

MEMO

001

9238334

coway

www.coway.co.kr