

coway

Coway Air Purifier User Manual

AP-1523D

MY

This product cannot be used if the voltage is different from that mentioned in the rating plate. For your safety and proper use of the product, please read this User Manual before use.
English

Dear customers

Thank you for using the Coway Air Purifier.

Please read this user manual carefully for correct use and maintenance of the product.

You can refer to the user manual to troubleshoot for product issues while using it.

Please keep this user manual in a safe place.

I. Please check before use!

- | | |
|--|----|
| 1. Safety Information | 3 |
| 2. Part Names | 11 |
| 3. Filter Installation and Replacement | 13 |

II. Understand the correct usage and functions

- | | |
|---|----|
| 1. Buttons and Indicators, Operation Method | 17 |
| 2. How to Use | 21 |

III. Learn how to clean and manage the product

- | | |
|-------------------------|----|
| 1. How to Clean Product | 24 |
| 2. How to Clean Filter | 26 |

IV. Familiarize yourself with information in advance for safe use

- | | |
|--------------------|----|
| 1. Error Code | 27 |
| 2. Troubleshooting | 29 |
| 3. Specification | 31 |

Danger Death or serious injury may occur if the instruction is not followed.



Power

Electric shock/fire

- Do not use a damaged or loose outlet.
- Make sure to connect the power plug to a 220 V- 240 V~ 50 Hz, 60 Hz outlet.
- Do not pull on the power cord to move the device.
- Do not touch the power plug with wet hands.
- To avoid damaging or warping the power cord, do not use excessive force to bend the power cord.
- Do not plug or unplug the power plug repeatedly.
- If water got into the power supply section, then disconnect the power adapter and completely dry it before use.
- Make sure the product is unplugged while the product is being repaired, inspected, or when its parts are being replaced.
- If there is any dust or water on the power plug's pins and contact area, wipe them off completely.
- Do not connect multiple products to one power outlet. Use a separate socket for the product.
- If you don't use it for a long time, then disconnect the power adapter.
- Do not modify the power cord arbitrarily.
- If the power cord is damaged, do not attempt to replace the cord. Instead, contact the service center to replace it.



Install

Fire
Fire/Electric shock/
Malfunction
Electric shock/Fire

- Do not install the product near an electric heating device.
- Do not place the product on top of an electrical appliance such as heater or television.
- Do not install the product in a location that is too humid, dusty, or exposed to water (rain) splashes.
- Do not use or store flammable gas or substance near the product.

Danger Death or serious injury may occur if the instruction is not followed.



Use

Electric shock

- Do not insert a sharp object, such as a drill, into the air quality sensor.

Injury/Malfunction

- Never immerse the product in water.
- Do not insert fingers or foreign objects (pin, stick, coin, etc.) into the air outlet.

Precaution for Kids Performance degradation

- Do not allow children to hang or climb on the product.
- Do not let children place their hands in the air outlet.
- When it is time to replace the filter, replace it with a new one.

Malfunction/ Electric shock Electric shock/Fire

- Do not spray water on the product.
- Do not arbitrarily open, repair, or improve the product.
- If there is any strange noise, burning smell, or smoke from the product, immediately unplug the power cord and contact the service center.
- Do not place bowls filled with water, chemicals, food, small metals, or flammable substances on top of the product.
- Unplug the power cord before cleaning the product.
- Do not spray water or use benzene or thinner on the product to clean it.

Fire/Performance degradation

- Do not spray flammable substances, such as pesticides or air fresheners, into the air inlet.

Warning Severe injury or property damage may occur.



Power

Fire
Fire/Electric shock/
Malfunction
Electric shock/Fire

- Do not pull the power cord.
- Plug the product into an outlet connected to an electric leakage breaker (sensitivity current less than 30 mA).
- If you wish to extend the power cord, use only sockets and cords of 220V - 240V and ensure that the socket is used for the product only.



Install

Electric shock/Fire

- Do not use the product in a place where it can be in direct contact with water, such as public bathroom, shower room, or swimming pool.

Warning Severe injury or property damage may occur.



Use

Malfunction

Injury/Malfunction Injury

- Do not apply excessive force on the product.
- Do not use the product for any purpose other than a purifier.
- Do not push or lean on the product. The product may fall.
- Do not expose the human body to the discharging wind from the front of the product for a long time.
- Do not put your face close to the discharging wind from the front of the product.

Caution Minor injury or property damage may occur.



Power

Electric shock/Fire

- Do not unplug or move the power plug while driving.
- If there is any strange noise, burning smell, or smoke when using the product, immediately unplug the power cord and contact the service center.

Caution Minor injury or property damage may occur.



Install

Injury/Damage

- Do not install it on a tilted surface.
- Do not install the product in a high place.

Performance degradation

Radio interference

- Do not apply excessive force or shock on the product.
- Maintain at least 20 cm from walls and surrounding objects.
- Install the product where it is not blocked from any side.

Performance degradation

- Maintain at least 2 m from electronic appliances such as television.

Discoloration/ Malfunction

- Do not use the product in a place where there is too much odor, smoke, or grease around it such as in a restaurant or barbecue place.
- Install the product away from direct sunlight.
- Do not touch the buttons with wet hands when power is being supplied.



Use

Ventilation
Malfunction
Abnormal
combustion/Smell
Performance
maintenance
Injury/Malfunction

- Periodically ventilate when using in an enclosed space.
- Make sure the air outlet is not blocked by laundry, curtain, etc.
- Use a vacuum cleaner or water to remove dust from the Pre-filter.
- Clean the Pre-filter regularly and dry it sufficiently in the shade with good ventilation to reuse.
- This appliance can be used by children aged from 8 years and above and persons with reduced physical, sensory or mental capabilities or lack of experience and knowledge if they have been given supervision or instruction concerning use of the appliance in a safe way and understand the hazards involved.
- Children shall not play with the appliance.

2 Part Names

Front/Rear

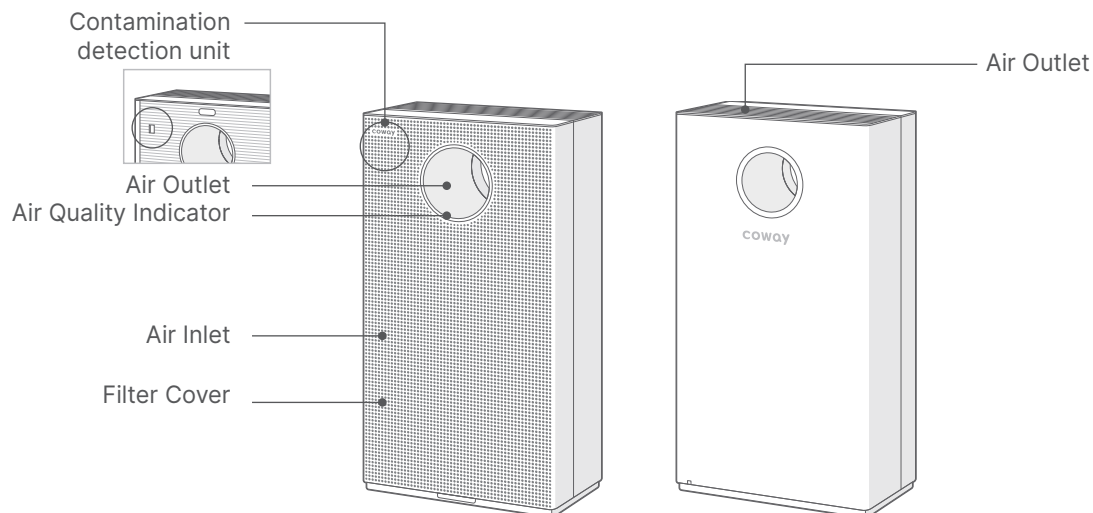

- Do not press the contamination detection part or poke it with a sharp object. There is a risk of breakage.

Top

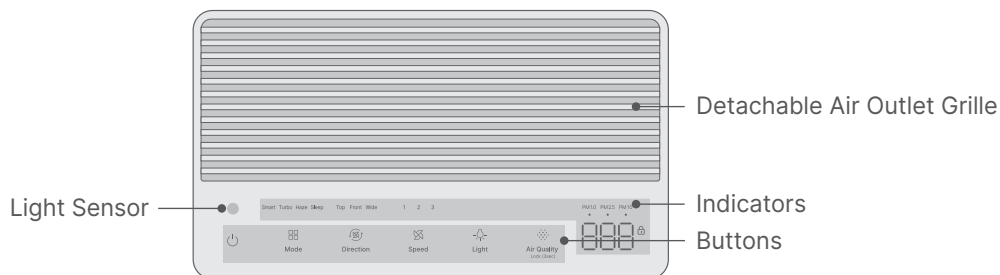

Accessories

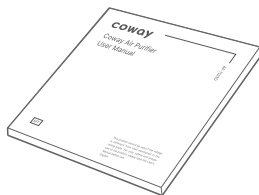

User Manual



Self Care Guide

Filter

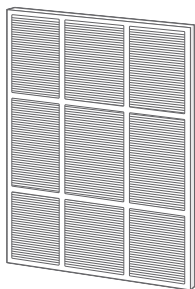

Pre-filter

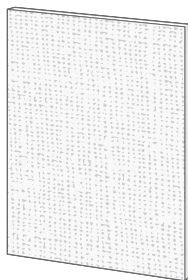

Fine Dust filter

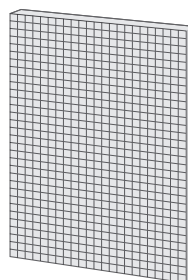

Double Deodorisation filter

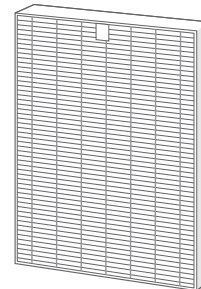

Double HEPA filter



- A Fine Dust filter is provided when purchasing the product for the first time.

3 Filter Installation and Replacement

Filter Type

Name	Maintenance Method	Cleaning/ Replacement Time	Function
Pre-filter	Clean and wash	Every 2 ~ 4 weeks	Removes relatively large dust particles, mold, hair, and pet hair. The superfine fiber net decreases filter pressure damage and improves dust collection efficiency.
Fine Dust filter	Replacement	Every 4 months	Effectively removes fine dust (PM10) and protects the dust collection filter.
Double Deodorisation filter	Replacement	Every 24 months	Effectively reduces odor and harmful gas with a Double Deodorisation filter made up of reinforced activated carbon.
Double HEPA filter	Replacement	Every 12 months	Efficiently remove ultra-fine dust particles and provides antibacterial functions.



- Based on 24 hours of daily use with Level 1 air speed.
- Filter replacement cycle is just a recommendation, and it depends on the environment of use.

Filter Installation

01. Before installation

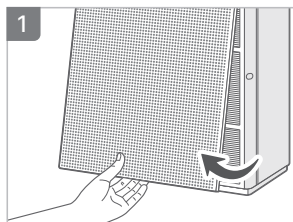

Pull the center bottom part to open the front cover.

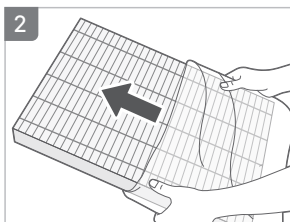

Remove the plastic packaging of the filters except for the Pre-filter.

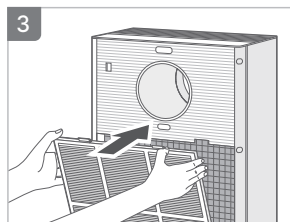

Assemble the Pre-filter and filter.

- Install the Fine Dust filter behind the Pre-filter.
- Filter assembly order:
Double HEPA filter →
Double Deodorisation
filter → Fine Dust filter
→ Pre-filter

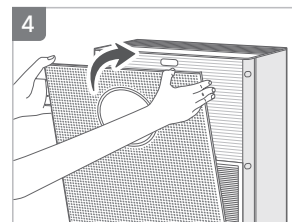

Close the front cover again.

- The product will not operate if the front cover is not attached correctly.



- Be sure to remove the plastic packaging before installing the filter.
- Use the product indoors only.
- Unplug the power cord from the outlet when not using the product.
- Check the front of the filter when installing it.

3 Filter Installation and Replacement

How to Replace by Filter Type

•Fine Dust filter

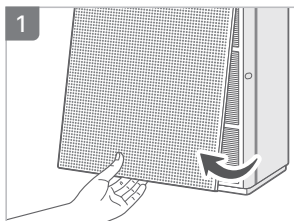

Pull the center bottom part to open the front cover.

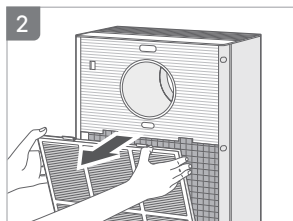

Detach the Pre-filter from the product.

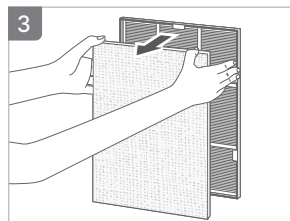

Remove the Fine Dust filter from the Pre-filter.

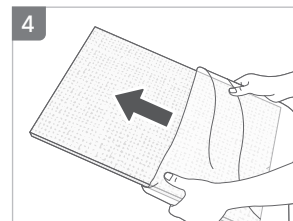

Remove the plastic packaging from the new Fine Dust filter.

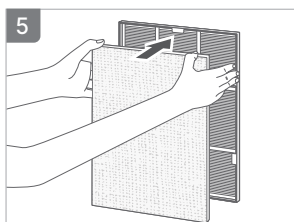

Put the new Fine Dust filter behind the Pre-filter.

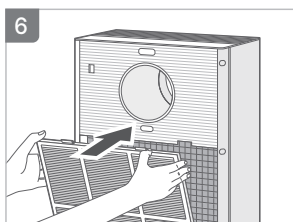

Assemble the Pre-filter into the product.

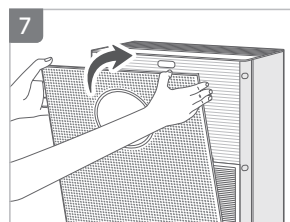

Close the front cover again.



•The filter replacement cycle may vary depending on usage environment and time.

•Deodorisation/Double HEPA filter

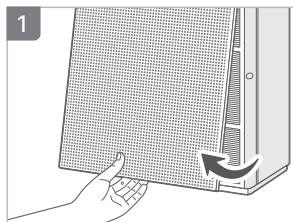

Pull the center bottom part to open the front cover.

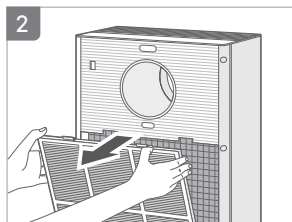

Remove the Pre-filter and Fine Dust filter from the product.

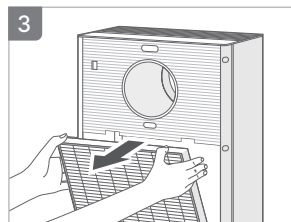

Separate the Double Deodorisation/Double HEPA filter.

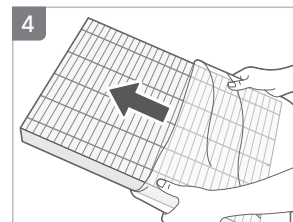

Remove the plastic packaging from the Double Deodorisation/Double HEPA filter.

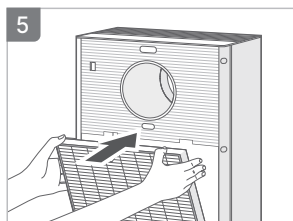

Replace the new Double HEPA/Double Deodorisation filter.

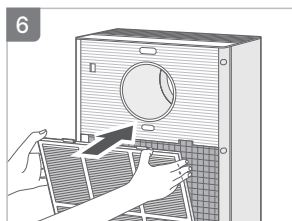

Assemble the Fine Dust filter and Pre-filter from the product.

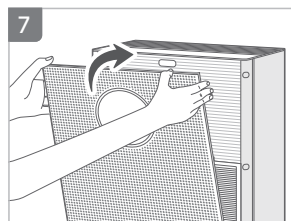

Close the front cover again.

- Filter assembly order:
Double HEPA filter →
Double Deodorisation
filter → Fine Dust filter
→ Pre-filter



•The filter replacement cycle may vary depending on usage environment and time.

Top

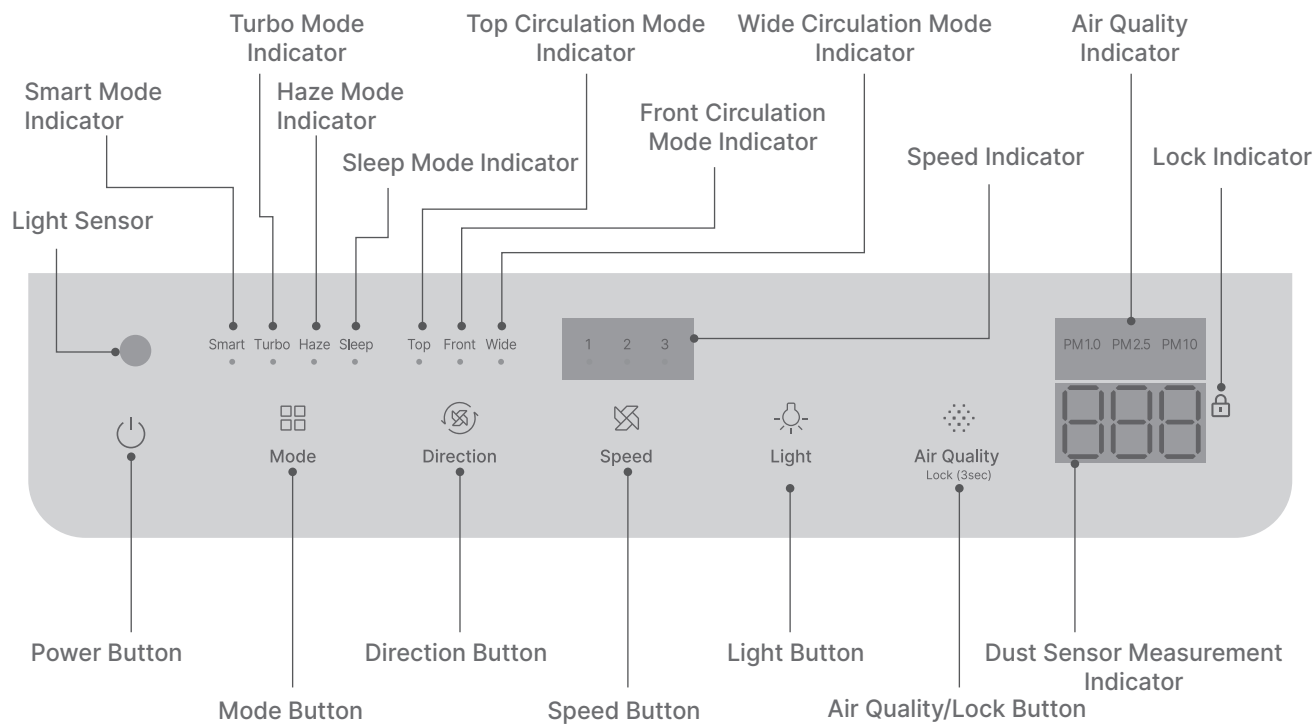



Power Button

Use the button to turn the product on and off.



Mode Button

Press the Mode button and choose the desired mode. Turbo Mode operates for a certain period of time before it operates as the top circulation Level 3 of Manual Mode. Haze Mode operates for a certain period of time before it operates as Smart Mode.



Direction Button

Press the Direction button and choose the desired air direction.

Press the Direction button to convert to Manual Mode.

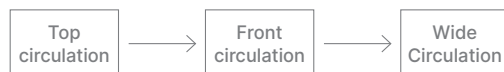

Speed Button

Press the Speed button to select the desired air speed.

Press the Speed button to convert directly to Manual Mode.



Light Button

Press the button to turn the Air Quality Indicator and other Indicators on and off. While the Air Quality Indicator and other Indicators are turned on, pressing the Light button repeatedly executes the following: Air Quality Indicator OFF → all other Indicators OFF → all Indicators ON.



Air Quality/Lock Button

[When using as the Air Quality Button]

Press the Air Quality Button to select the dust size for measurement display. The selected value will be displayed for 10 seconds before displaying it as the fine dust size with the highest pollution level.



[When using as the Lock button]

You can lock all the buttons by pressing and holding this button for more than 3 seconds. Press the button again for more than 3 seconds to unlock the buttons.

Smart

Smart Mode Indicator

The Indicator lights up when Smart Mode is selected.

Turbo

Turbo Mode Indicator

The Indicator lights up when Turbo Mode is selected.

Haze

Haze Mode Indicator

The Indicator lights up when Haze Mode is selected.

Sleep

Sleep Mode Indicator

The Indicator lights up when Sleep Mode is selected.

Top

Top Circulation Mode Indicator

The Indicator lights up when Top Circulation Mode is selected.

Front

Front Circulation Mode Indicator

The Indicator lights up when Front Circulation Mode is selected.

Wide

Wide Circulation Mode Indicator

The Indicator lights up when Wide Circulation Mode is selected.

3
2
1**Speed Indicator**

The Indicator lights up when air speed is selected.

PM10
PM2.5
PM1.0**Air Quality Indicator**

This indicates air quality level.

**Light Sensor**

This sensor detects light around the product.

**Lock Indicator**

When all buttons are locked, the Indicator blinks twice and lights up.

**Air Quality Indicator**



This Indicator displays the indoor air quality in LED colors.

Good: Blue, Normal: Green, Bad: Yellow, Very Bad: Red

Air Quality Sensor Sensitivity Adjustment

1

Button operation

Press the Mode button and the Speed button at the same time for more than 3 seconds.

2

Indicators

828

The dust sensor measurement display flashes at an approximately 0.5 second interval.

3

Button operation



→

828

Press the Speed button to adjust it to the desired sensitivity.
(1: Sensitive, 2: Normal, 3: Insensitive)

4

Button operation

Press the Mode button and the Speed button at the same time for more than 3 seconds again.

- The selected sensitivity of the sensor is automatically entered if the Speed/Direction buttons are not pressed for 10 seconds.

Air Quality Indication Guide

Classification	Good (blue)	Normal (green)	Bad (yellow)	Very bad (red)
PM 1.0 ($\mu\text{g}/\text{m}^3$)	0 ~ 15	16 ~ 35	36 ~ 75	76~
PM 2.5 ($\mu\text{g}/\text{m}^3$)	0 ~ 15	16 ~ 35	36 ~ 75	76~
PM 10 ($\mu\text{g}/\text{m}^3$)	0 ~ 30	31 ~ 80	81 ~ 150	151~

- PM 2.5 concentration guide and color display criteria are based on the guide provided by the Ministry of Environment and for the numeric expression of concentration, the company's algorithm is applied. Normal is the default setting for product contamination, and if you change the setting to Sensitive or Insensitive, it will be displayed higher or lower than the default PM 2.5 concentration.
- The concentration of dust displayed on the product measures the indoor environment real time, so it may differ from the guide of the Ministry of Environment and may differ depending on the place of use, environment of use, measurement method, etc.
- The maximum value of dust concentration displayed on the product (PM1.0 / PM2.5: $500 \mu\text{g}/\text{m}^3$, PM10: $999 \mu\text{g}/\text{m}^3$).
- If the humidifier is operated near the purifier, the air quality measurement may rise.
- As the ultrasonic humidifier has large humidifying droplet particles, the dust sensor can recognize them as dust, thereby causing a malfunction in the dust sensor. So use it away from the purifier.
- If the dust air quality level continues to display the maximum value.
Therefore, clean the dust sensor, turn off the power of the product and then turn on again so that it can operate normally.
- It displays the color of the bad condition among PM 1.0 / PM 2.5 / PM 10.

Tips

- Plug the power cord into an outlet before operating the product.
- The product operates in Smart Mode by default when turned on.

Mode Selection

It operates automatically according to the set program.

Press the Power button to turn on the product, and press the Mode button to select the desired mode among Smart/Turbo/Haze/Sleep.

Button operation



01. Smart Mode

When the surroundings of the product become dark for more than 3 minutes, it automatically enters the sleep mode (low air volume, low noise, low power consumption operation). If the surroundings of the product become bright again for more than 5 minutes, the sleep mode is released.

Button operation



In Top Circulation Mode, air is discharged from the air outlet at the top of the product.

02. Turbo Mode

Maximizes the air speed while operating to create a comfortable environment in a short period of time.

The turbo operates at a higher speed than the level 3 speed.

After 10 minutes of operation, it operates in Level 3 of Top Circulation Mode.

Button operation



03. Haze Mode

It is an operation mode that can effectively remove indoor dust within the shortest time.
It operates automatically and continuously for a certain period of time at the maximum air speed in 3 levels.

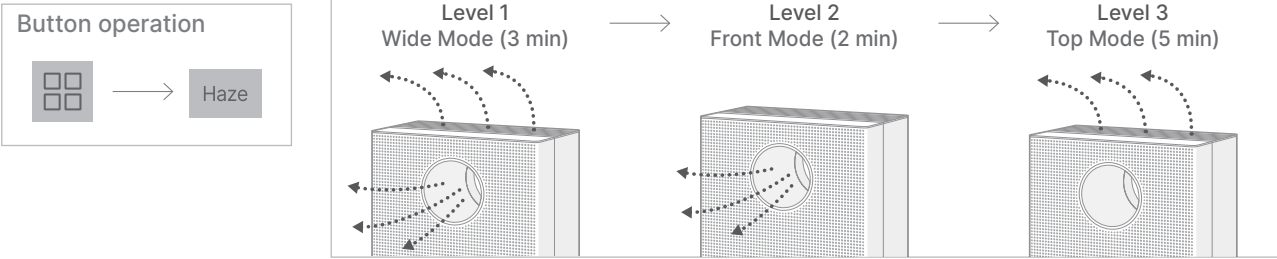

- Haze Mode works only with the turbo air speed.
- In Haze Mode, the airflow direction and Air Quality Indicators operate for each mode. Regardless of each level mode, only the Haze Mode Indicator lights up.
- When 3 levels of Haze Mode are completed, operation is converted to Smart Mode.
- If you press the Mode/Air direction/Air speed button during the Haze Mode, Haze Mode is canceled.

04. Sleep Mode

It is a driving mode suitable for a sleeping environment by minimizing the air volume and Indicator light while driving.

After about 5 seconds of sleep mode operation, all Indicators other than the sleep mode Indicator will turn off.

If you press the Light Button or Air Quality selection Button during sleep mode,
The current air quality reading is displayed in low brightness for about 5 seconds.



2 How to Use

Manual Mode

In Manual mode, the user selects the desired air direction and air speed by pressing the direction/speed button.

01. To select the direction

Press the Direction button to select the desired air direction.

- Even during mode operation (Smart/Turbo/Haze/Sleep), if you press the Direction button immediately, it switches to manual operation.

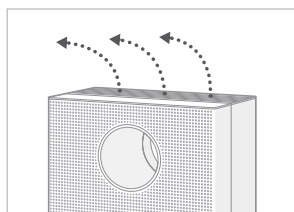
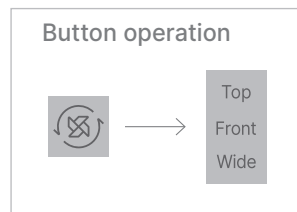

Top Circulation
Wind comes from the top of the product.

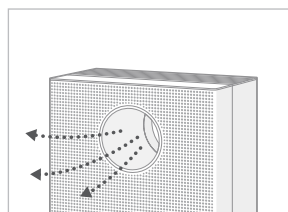

Front Circulation
Wind comes from the front of the product.

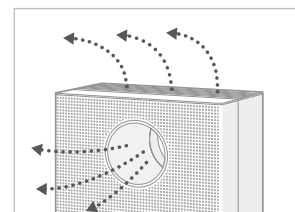

Wide Circulation
Wind comes from the front and top of the product at the same time.

02. To select the air speed

Press the Speed button to select the desired air speed.

- Even during mode operation (Smart/Turbo/Haze/Sleep), if you press the Speed button immediately, it switches to manual operation.



1 How to Clean Product

Cleaning the air outlet and detachable outlet grille

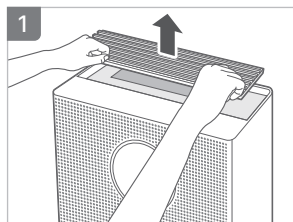

Lift the detachable outlet grille on top of the air outlet

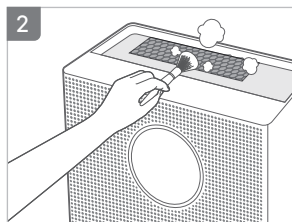

Clean the grille and air outlet with a soft brush or vacuum.

- Do not let dusts drop into the air outlet when you clean it.

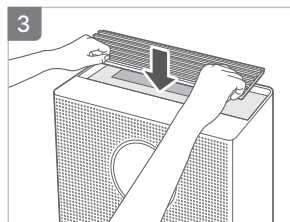

Reassemble the detachable outlet grille on top of the outlet.

Cleaning of Air Quality Sensor (Every 2 months)

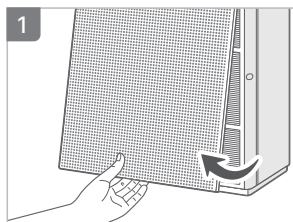

Pull the center bottom part to open the front cover.

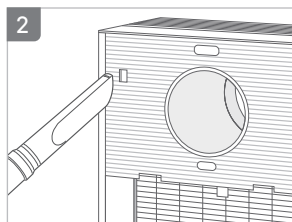

Use a soft brush or vacuum cleaner to clean the air inlet and the air outlet of the air quality sensor.

- Do not let dusts drop into the product when you clean it.

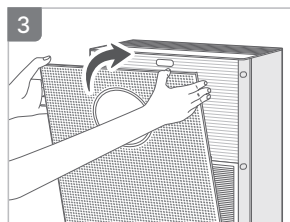

Close the front cover again.

1 How to Clean Product

Cleaning of Front Cover

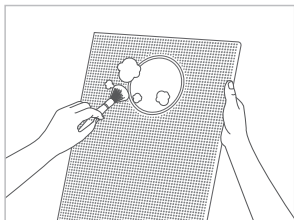

After separating the front cover from the product, use a soft cloth or brush to wipe off dusts on the surface.

- If the degree of pollution is severe, use a slightly wet cloth to wipe it. (Do not use an abrasive surface or chemicals for cleaning.)

Cleaning of Main Body

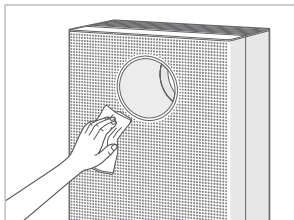

Use a dry and soft cloth to wipe it.

- If the degree of pollution is severe, use a slightly wet cloth to wipe it. (Do not use an abrasive surface or chemicals for cleaning.)

2 How to Clean Filter

III

Maintenance

IV

Pre-filter

Clean the Pre-filter every 2~4 weeks. (The cleaning cycle varies depending on the use environment.)
Failure to clean the filter for a long time may result in poor product performance.

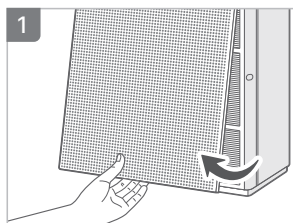

Pull the center bottom part to open the front cover.

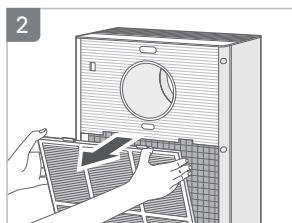

Detach the Pre-filter from the product.

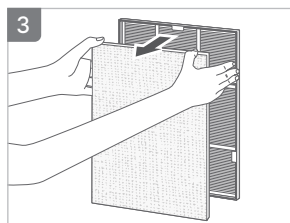

Detach the Fine Dust filter from the Pre-filter.

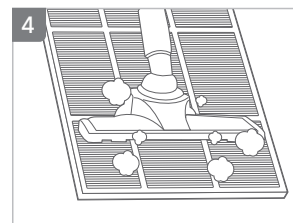

Remove dust with a vacuum cleaner or water depending on the degree of contamination.

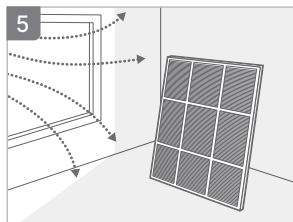

When cleaning with water, dry completely in a well-ventilated shade.

[Precaution] If you dry it in direct sunlight or near a dryer, heater, or other heat-generating devices, the Pre-filter may be deformed and the product may not function properly.

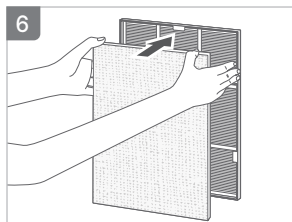

Assemble a Pre-filter and a Fine Dust filter.

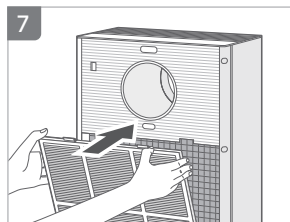

Assemble the Pre-filter into the product.

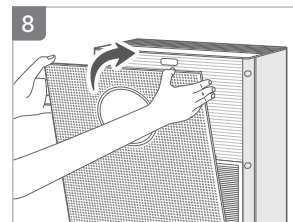

Close the front cover again.



- Always unplug the power cord before cleaning the filter.
- The Pre-filter can be restored by removing dust or washing with water.
- Failure to clean the Pre-filter for a long time may result in poor product performance.
- Double HEPA filter, Deodorizing filter, and Fine Dust filter cannot be reused after washing.
- Never wash these filters with water.

If an error code as shown below appears while using the product, check the cause of the error and operate according to the guide.



Fan Motor Operation

This error will be displayed when there is no RPM signal detected for about 6 seconds while the air purifier is operating. A fan and a motor stop.

[Resolution Guide]

Turn off the power, unplug the power cord, and plug it back in again for operation.



Fan Motor Rotation

This error will be displayed if it operates for about 10 minutes at 100 RPM higher or lower than the set RPM. A fan and a motor stop.

[Resolution Guide]

Turn off the power, unplug the power cord, and plug it back in again for operation.



Dust Sensor

This error will be displayed if the dust sensor does not last for more than 10 seconds or the fan of the dust sensor does not operate while using the product. A fan and a motor stop.

[Resolution Guide]

Turn off the power, unplug the power cord, and plug it back in again for operation.



Front and Rear Motion of Direction Control

This error will be displayed when the motion of the wind blade is abnormal during direction control. A fan and a motor stop.

[Resolution Guide]

If you press any button in an error state, it tries the operation again after the error is cleared. Make sure there are no debris or bindings in the upper outlet before retrying.



Buttons

This error will be displayed when a button on the control panel is continuously pressed for more than 30 seconds. A fan and a motor stop.

[Resolution Guide]

Check that there are no objects or foreign substances near the control panel and remove them. If what the control panel detects is cleared, it will be automatically restored.



Filter Cover

When the filter cover is not properly installed, it flashes at about 1-second intervals.

[Resolution Guide]

Please check the filter cover and filter again and mount it.

2 Troubleshooting

The air purifier may malfunction due to lack of familiarity and minor causes.

If the problem persists after checking the items below, please contact the service center.

Symptom	Checkpoint	Measures to take
No air is coming out.	Is the power cord plugged in?	Plug the power cord into a 220 V-240 V~ 50 Hz, 60 Hz outlet.
	Are all the Indicators off?	Press the Power button and select the desired function.
	Is there a power outage?	Use the product after the electricity is restored.
The air speed does not change.	Is it operating in Manual Mode?	Set the desired operation mode.
	Are the Turbo and Sleep Mode indicators on?	The air speed cannot be selected in Turbo and Sleep Modes, and it is fixed at the set air speed.
	Is the room dark?	It is fixed at the minimum air speed during Sleep Mode operation.
	Is Haze Mode indicator on?	It is fixed at the maximum air speed during Haze Mode operation.
The air speed has weakened considerably.	Has the filter cleaning or replacement time passed?	Check the filter cleaning and replacement cycle and clean or replace the filter.

The air purifier may malfunction due to lack of familiarity and minor causes.
 If the problem persists after checking the items below, please contact the service center.

Symptom	Checkpoint	Measures to take
The pollution level does not change.	Is there dirt on the air quality sensor?	Clean the air quality sensor. (Refer to P. 23.)
	Does the air quality remain at High?	Adjust the air quality sensor's sensitivity to Insensitive or Normal. (Refer to P. 19.)
	Does the air quality remain at Low?	Adjust the air quality sensor's sensitivity to Sensitive or Normal. (Refer to P. 19.)
There is a bad smell coming out from the outlet.	Has the filter cleaning or replacement time passed?	Check the filter cleaning and replacement cycle and clean or replace the filter.
The wind direction is different from the setting.	When the air purifier recognizes in the direction of the wind, a 'humming' sound may occur, and it will operate normally after about 1 minute. If it lasts more than 1 minute, apply for service and contact us.	
There is a 'humming' sound.		
There is a 'buzzing' sound.	When the wind direction changes, a 'buzzing' sound may occur. It works fine when the wind direction changes.	
The Air Quality Indicator is flashing.	Contact the service center.	
Other functional defects	Check the problem, unplug the power cord, and contact the service center.	

3 Specification

Product name	Air Purifier
Model name	AP-1523D
Rated voltage	220- 240 V~ 50 Hz , 60 Hz
Phase	Single phase
Power consumption	42 W
Product insulation class	Class 2 equipment
Dust collection method	Mechanical dust collection method (Double HEPA filter)
Safety device	Door Controlled Switching Device
Installation location	For indoor use
Product dimensions	412 mm (width) × 232 mm (length) × 752.5 mm (height)
Product weight	12 kg

- Design and specification may change without any prior notice for application of statutes, product improvement, and quality enhancement.

I

II

III

IV

Others

I

II

III

IV

Others

001

9242516

coway

www.coway.com.my