

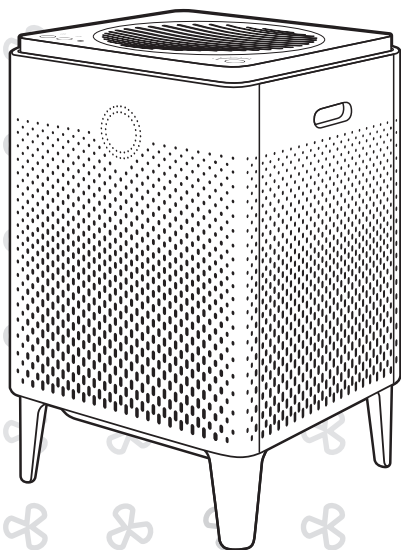

Coway Air Purifier AP-1717A

- This product is for domestic use only. It cannot be used in an overseas country where the power voltage is different.
- Read and save these instructions.



FEATURES

1. Powerful air circulation with new dual intake

New simultaneous dual absorption on the purifier side provides powerful air circulation.



2. Faster, more powerful dual filter system

Enhanced dust collection and deodorisation with a powerful dual filter system.

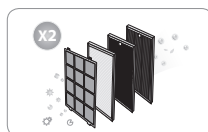

3. Smart Eco mode

Automatically controls fan operation according to pollution level to reduce energy consumption and standby power.



4. Compact, optimised purification

This customised design is 70% the size of our standard products and features optimised purification that is even more outstanding inside homes.



DEAR CUSTOMERS

Thank you for using the **Coway air purifier**.

Please be sure to read this user manual to use and maintain your air purifier correctly.

If you experience any problems during usage, you can refer to this user manual to resolve them.

CONTENTS

PRODUCT INFORMATION

- | 03 | **SAFETY INFORMATION**
 - Danger
 - Warning
 - Caution
- | 07 | **PARTS NAME**
- | 09 | **AIR PURIFICATION PROCESS**

MAINTENANCE

- | 14 | **CLEANING METHOD**
 - Product
 - Filter
- | 16 | **FILTER REPLACEMENT**

HOW TO USE

- | 10 | **BEFORE USE**
 - How to install filter
- | 11 | **INDICATORS AND BUTTONS**
- | 13 | **HOW TO USE**

OTHERS

- | 18 | **TROUBLE SHOOTING**
- | 19 | **SPECIFICATION**

- Keep your user manual in a readily accessible or visible place. -

SAFETY INFORMATION

This is safety information. Be sure to follow it!

The warnings are to keep users safe and avoid damage to the product.
Please read them carefully and use the product correctly.

▲ Danger : Failing to follow the precautions below may result in serious injury or even death.

- Do not use damaged power plugs or loose sockets.
- The power plug must be plugged into sockets of 220V-240V / 50Hz - 60Hz only
- Do not pull on the power cord to move the device.
- Do not touch the power plug with wet hands.
- To avoid damaging or warping the power cord, do not use excessive force to bend the power cord or put heavy objects on top of it.
- Do not repeatedly connect and disconnect the power plug.
- If water enters the power supply, unplug the power plug and dry it completely before using it again.
- Be sure to unplug the power during product repair, maintenance or part replacement.
- If the power plug's pins or contact area become covered in dust or water, wipe them thoroughly.
- Do not plug several electrical appliances into one socket, and use only a dedicated socket.
- Unplug the power when not used for a long time.
- Do not carelessly connect or tamper with the power cord.
- If the power cord is damaged, do not replace it yourself. Contact a service center to have it replaced.
- Do not install near electric heaters.
- Do not put on top of electric products like heaters or televisions.

-
- Do not install in places with high humidity or dust or places where water (rainwater) splashes.
 - Do not use or store combustible gases or flammable materials near this product.
 - If there is a strange sound, burning smell, or smoke from the device, immediately unplug the power plug and contact a service center.
 - Never immerse the product in water.
 - Do not spray flammable materials such as insecticides or air fresheners on the intake.
 - Do not open, repair, or modify the device yourself.
 - Do not put bowls of water, chemicals, food, small metal objects, or flammable materials on top of this product.
 - Unplug the power cable before cleaning.
 - If the purifier falls over and gets wet during use, A/S maintenance is required before further use.
 - Do not spray water directly on the device or use benzene, thinners, etc. to wipe it during cleaning.
 - Do not insert sharp objects such as picks into the pollution sensor.
 - Do not put fingers or foreign matter (pins, sticks, coins, etc.) into the vent.
 - Do not let children hang from or climb on the purifier.
 - Be careful that children do not put their hands in the vent.
 - Replace the filter with a new one according to the schedule.
 - Do not spray water directly on the purifier.

SAFETY INFORMATION

▲ Warning : Failing to follow the precautions below may result in considerable physical injury or property damage.

- Do not unplug by pulling on the power cord.
- Plug into a power socket connected to an earth leakage circuit breaker (current sensitivity 30 mA or less).
- If you wish to extend the power cord, use only sockets and cords of 220V - 240V and ensure that the socket is used for the product only.
- Do not use in baths, showers, swimming pools, or other areas where the purifier may be in direct contact with water.
- This appliance is not intended for use by persons (including children) with reduced physical, sensory or mental capabilities, or lack of experience and knowledge, unless they have been given supervision or instruction concerning use of the appliance by a person responsible for their safety.

//////////

⚠ Caution : Failing to follow the precautions below may result in slight physical injury or property damage.

- Do not unplug the power or move the purifier while it is operating.
- If unusual sound, odor, or smoke comes from the purifier, immediately unplug the power and call our service center
- Do not install on a slope.
- Do not excessively impact or use excessive force on this product.
- Use at least 20 cm away from walls or other objects on each side.
- Install the purifier in a place where it is not blocked on any side so air can circulate well.
- Install at least 2 m away from TVs and other electronic items.
- Do not use in BBQ or other restaurants where odor, smoke, or oil may occur.
- Do not use in direct sunlight.
- Do not install in a high place.
- Do not use extreme force on the purifier.
- Do not push or lean on the purifier. The purifier may fall over.
- Do not use for a long time in places that are enclosed or where children, the elderly, or sick people are.
- Do not block the vent with laundry or curtains.
- Remove dust from the pre-filter with a vacuum cleaner or water.
- Periodically wash the pre-filter and dry it well in a shady place with good ventilation.
- People with physical, sensory, or emotional impairment as well as children must be supervised or guided while using the device.
- This wireless equipment may interfere with electric waves and cannot perform services related to human safety.

PARTS NAME

Front

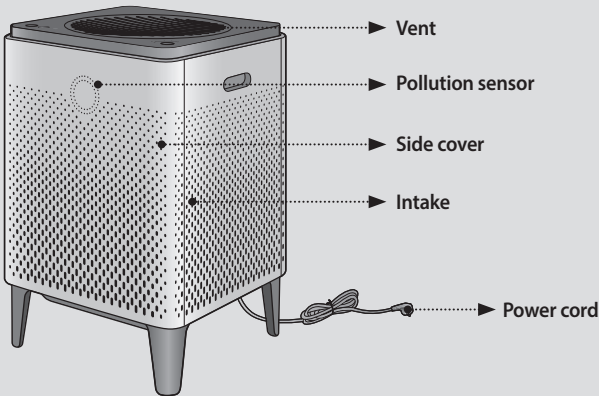

Top

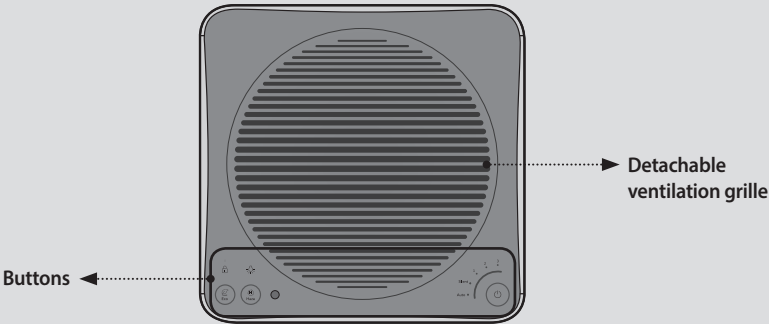

Components



User Manual

AIR PURIFICATION PROCESS

■ Pre-filter

Removes large dust and mold, hair, pet fur, etc.

■ Customised filter

Provides a customised filter perfect for different situations, seasons, and spaces.

■ Deodorising filter

The granular activated carbon deodorising filter effectively removes odors including food smells and unpleasant household odors and harmful gases.

■ HEPA filter

The high-performance synthetic HEPA filter is excellent at removing cigarette smoke and fine dust.

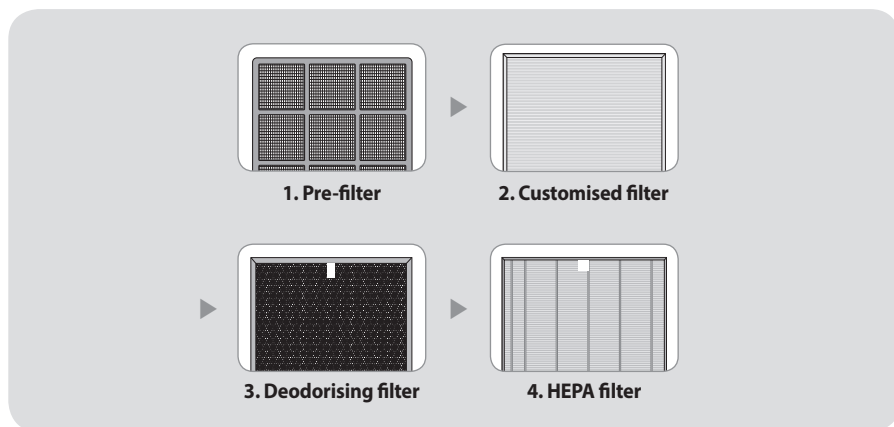

BEFORE USE

Please check before use

This product is exclusively 220V - 60Hz.

The power plug must be plugged into grounded sockets of 220V - 240V / 50Hz - 60Hz only.



How to install filter



Tips

- Be sure to install the filter after removing the plastic packaging.
 - Only use it indoors.
 - When not in use, remove the power plug from the socket.
 - During filter assembly, check the front of the filters.
- Filter assembly order: HEPA filter → Deodorising filter → Customised filter → Pre-filter

1. Open the side cover.

Pull the upper part of the side cover to open.

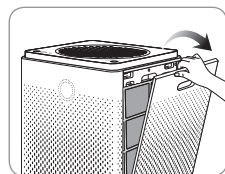

2. Take out the filter and remove the plastic packaging.

Remove the plastic packaging from filters, excluding the pre-filter, and assemble them in the purifier in order. |

- ※ Filter assembly order: HEPA filter → Deodorising filter → (Customised filter) → Pre-filter

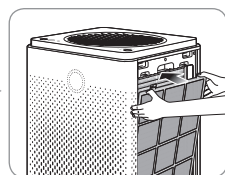
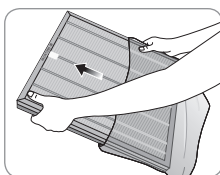

3. Reattach the side cover.

Fit the two tabs on the bottom part of the side cover into their slots and push to install.

- ※ If the side cover is not properly attached, the product will not operate.



INDICATORS AND BUTTONS

Indicators

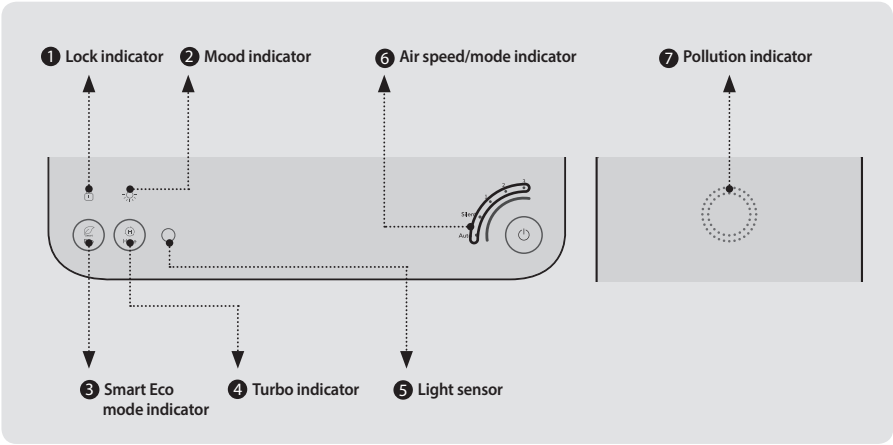

1 Lock indicator
This indicator is illuminated when the lock feature is in use.



2 Mood indicator
The mood indicator LED is on when the pollution indicator is on.



3 Smart eco mode indicator
This indicator is illuminated when smart eco mode is in use.



4 Turbo indicator
This indicator is illuminated when turbo mode is operating with turbo air speed for a set period of time.



5 Light sensor
This sensor detects light around the device.



6 Air speed/mode indicator
Indicates current air speed and mode.



7 Pollution indicator
Shows indoor air pollution level using colors.

Pollution	Indoor
1 (Low)	Blue
2 (Moderate)	Green
3 (High)	Yellow
4 (Very high)	Red

Buttons

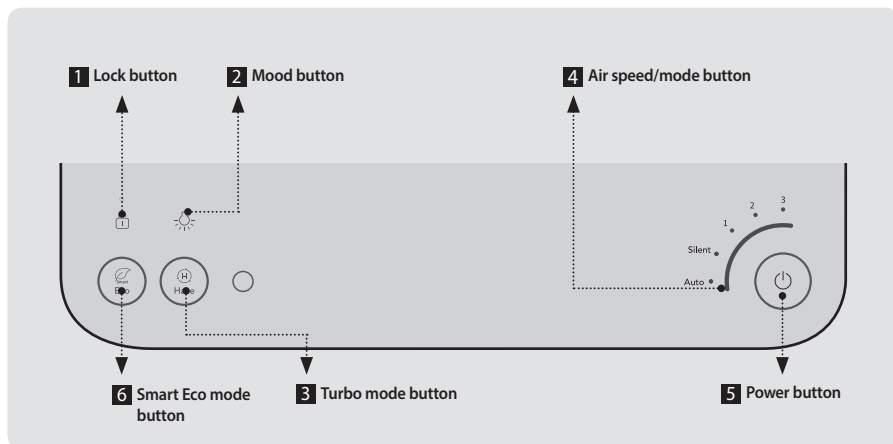
**1 Lock button**

Turn the lock feature on or off by pressing and holding the lock button

**2 Mood button**

Turns the indicator on or off.
Cycles through all indicators on → pollution indicator off → all indicators off → all indicators on when pressed.

**3 Turbo mode button**

Use when turning turbo mode on. Press the turbo button to run turbo mode for about 10 minutes.

**4 Air speed/mode button**

Touch and drag to select air speed/mode and change from auto mode to 3 air speed levels.

**5 Power button**

Power on/off; touch and hold for at least 2 sec.

**6 Smart eco mode button**

Automatically controls the fan according to indoor air pollution level to reduce energy use and standby power.

HOW TO USE



Tips

- Plug the power plug into a socket before operating the purifier.
- When you first turn on the purifier, it runs in manual mode. Later, it runs in the mode in which it was last used.

■ To use manual mode

Press the power button to turn on the purifier and drag the air speed/mode button to select your desired air speed.

(Silent → Level 1 → Level 2 → Level 3)

- * Press the air speed button during auto mode to immediately switch to manual operation.

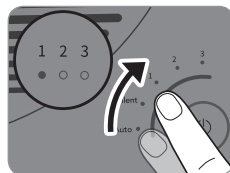
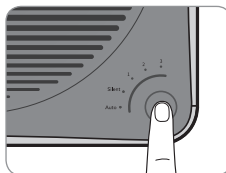

■ To use auto mode

Press the power button to turn on the purifier and drag the air speed/mode button to select auto mode.

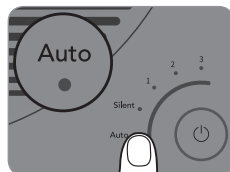
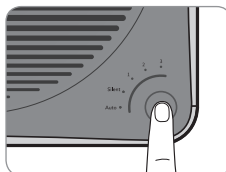

► Auto mode

Operates effectively by automatically adjusting the purifier's fan speed (level 1 → level 2 → level 3) depending on the indoor pollution level detected by the sensor. This is a convenient operating mode for most users.

	Pollution level 1	Pollution level 2	Pollution level 3, 4
Air speed	Level 1	Level 2	Level 3

► Silent mode

Minimizes fan speed during operation to create a quiet, comfortable environment.

This operating mode is quiet and consumes less power.

- * The air speed indicator is off during silent mode.

■ To use smart eco mode

Press the smart eco button to adjust the fan according to indoor air pollution.

- * If indoor air is kept clean for over 10 minutes while in smart eco mode, the fan will stop within a maximum of 30 minutes.
- * If pollution is still detected while the fan is stopped and indoor air pollution worsens, the fan will immediately turn on to purify the air.
- * If indoor air is kept clean for at least 10 minutes after the fan restarts, the purifier will stop the fan again.

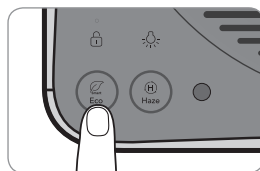

■ To use turbo mode

When you press the turbo button, the turbo indicator turns on and turbo mode runs for 10 minutes.

After 10 minutes, the purifier reverts to its previous operating mode.

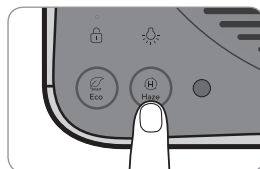

CLEANING METHOD



Tips

- Always unplug the power before cleaning.
- Do not use detergents containing organic solvents (solvents, thinners, etc.), bleach, chlorine, or abrasives to clean.
- Do not immerse the purifier in water or sprinkle water on it.

■ Cleaning the vent and detachable ventilation grille

Turn the detachable ventilation grille on top of the vent counterclockwise to remove, then clean the grille and vent with a soft brush.

* Be careful not to let dust enter the vent while cleaning.

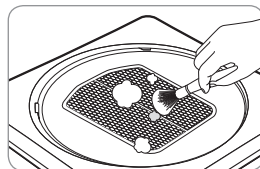
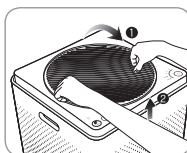

■ Cleaning the pollution sensor (clean every 2 months)

1. Clean the pollution sensor air intake and vent with a soft brush.

* Be careful not to let dust enter the vent while cleaning.

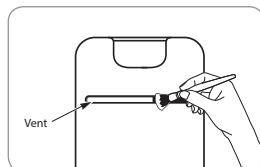

2. Remove the purifier's front cover and open the pollution sensor cover. Wet a cotton ball with a small amount of water and wipe the lens, dust intake, and outlet, then wipe again with a dry cotton ball to remove moisture.

* If cleaning is not done regularly, the performance of the pollution sensor may decrease.

* Clean more often for product used in very dusty environments.

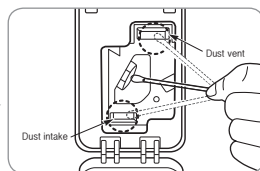
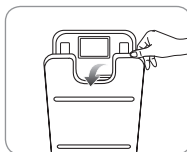

■ Cleaning the side cover

Remove the side cover from the purifier and then wipe away dust stuck to the surface with a soft, dry cloth or soft brush.

* If there is severe contamination, use a damp cloth (do not use abrasives).

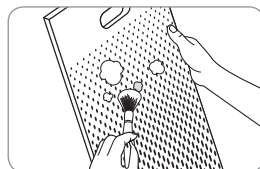

■ Cleaning the purifier

Wipe with a soft, dry cloth.

* If there is severe contamination, use a damp cloth (do not use abrasives).

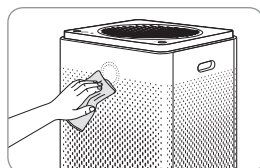

CLEANING METHOD



Tips

- Always unplug the power before cleaning the filters.
- The pre-filter can be reused after removing dust and cleaning with water.
- If the pre-filter is not cleaned for a long time, the product performance may decrease and problems may occur.
- The deodorisation filter and HEPA filter cannot be reused after cleaning. Never clean them with water.

■ Pre-filter (clean every 2-4 weeks)

1. Pull the upper part of the side cover to open.

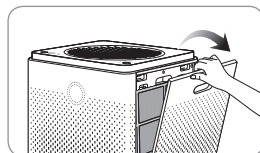

2. Pull the pre-filter handle to take it out.

* Be careful that dust doesn't fall out during removal.

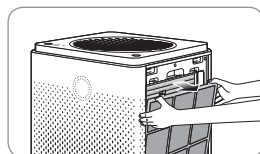

3. Remove dust with water depending on the degree of contamination.

* Be careful not to let dust enter the purifier while cleaning.



4. Push the completely dry pre-filter all the way into the purifier to install it.
Close the side cover again.

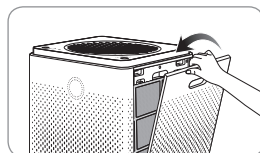
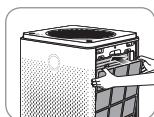

FILTER REPLACEMENT

■ How to replace

- Refer to the filter installation method specified on page 10 to replace the filters.
- During filter assembly, be sure to check the front-facing direction.
- Only use genuine Coway filters to keep the purifier at its optimal performance.
- Always unplug the power plug before replacing filters.

■ Filter cleaning and replacement cycle

Filter	Cleaning / replacement time	Cleaning / replacement
Pre-filter	2-4 weeks	Clean and wash
Customised filter	4 months	Replace
Deodorisation filter	24 months	Replace
HEPA filter	12 months	Replace

* Based on 24 hour (1 day) use at low air cleaning level

* The filter replacement cycle is the recommended cycle and may vary depending on where the purifier is used.

FILTER REPLACEMENT

■ Replacing the customised filter (replace every 4 months)

1. Open the side cover and remove the pre-filter from the purifier, then take out the customised filter

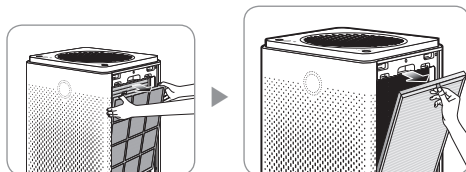

2. Remove the plastic packaging from the new customised filter, then insert it into the purifier.
Insert the pre-filter into the purifier in the reverse order you removed it, then close the side cover.

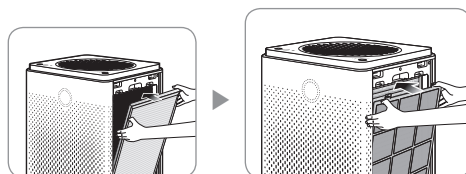

■ How to replace deodorisation/HEPA filters (replace every 24 months)

1. Open the side cover and remove the pre-filter and customised filter from the purifier, then take out the deodorisation filter and HEPA filter.

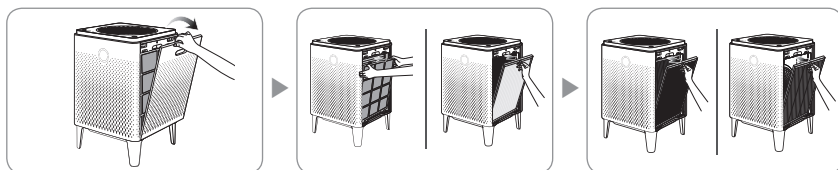

2. Replace them with a new deodorisation filter and new HEPA filter with the plastic packaging removed.
Reassemble the purifier in the reverse order you disassembled it and close the side cover.

* Check the filters' front display.

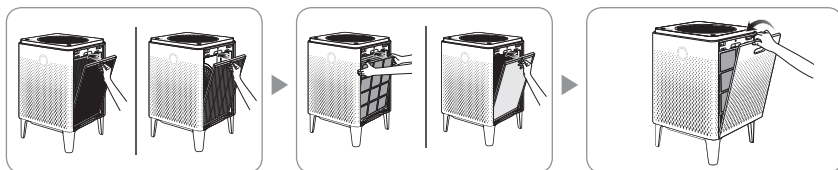

TROUBLE SHOOTING

The product may not operate correctly for trivial reasons or due to unfamiliar methods of use which does not signify product malfunctions. In such cases, the problem can be solved easily without the help of service centre if the following items are checked. If the problem is not resolved even after checking the following, please contact a service centre.

Problem	Check	Possible Solutions
There is no breeze.	• Is the power plugged in?	The power plug must be plugged into a 220V - 240V / 50Hz - 60Hz socket only.
	• Is the entire display off?	Press the power button, then select your desired function.
	• Is there a power failure?	After the power comes back on, use the purifier.
Air speed doesn't change.	• Is the automatic indicator off?	You can only select air speed in manual mode (normal).
	• Is the silent indicator off?	You can only select air speed in manual mode (normal).
Air speed is very low.	• Check whether the filter is clean.	Check whether the filter is clean and clean the filter.
Pollution level doesn't change.	• Is there dust on the pollution sensor lens ?	Clean the pollution sensor lens (p. 14).
The pollution indicator flashes.	• Request for service.	
If other functional flaws occur	• Check the problem, then unplug the power and request for service.	

SPECIFICATION

Product name	Air purifier
Model name	AP-1717A
Rated voltage	220 V - 240 V ~ 50 Hz, 60 Hz
Phase	Single-phase
Power consumption	27 W
Product insulation grade	Class 2 device 
Dust collection method	Mechanical dust intake (HEPA filter)
Safety equipment	Door opening/closing power blocker
Installation location	For indoor use
CA-certified rated area	56.4 m²
Maximum air volume	5.1 m³/min
Rated fan speed	7.8 CMM
Volume	43.1 dB
Product size	375 mm (width) x 375 mm (depth) x 580 mm (height)
Net weight	11.2 kg
CA certification number	CA03BB15

► Product design and specifications are regulated by law and are subject to change without notice to improve the product or its quality.

MEMO

////////////////////////////////////

MEMO

////////////////////////////////////

MEMO

////////////////////////////////////

